

FITTING INSTRUCTIONS

DOCUMENT TITLE:
FI-BP80874-A

APPLICATION:
Ford Ranger / Everest MY22+
SA326BL325
SA327BL325

MODEL NUMBER:
BP80874 -
Aftermarket Led Fog Light 70mm OD

FITTING TIME:
Minimum 10 Min.
(When fitted with bar)

PUBLISHED DATE:
29 July 2025

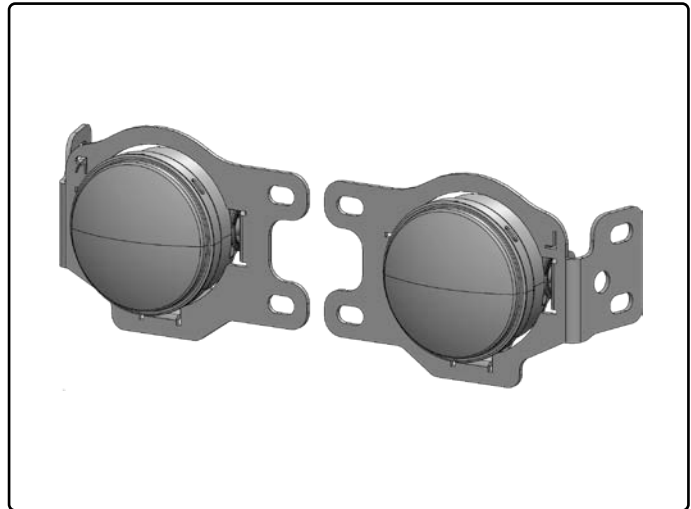

INSTALLATION

NOTE: Do not discard removed hardware and components until installation is complete.

1.1
Remove 325WCR plate behind the wheel arch as shown.

Repeat on other side.

Tool(s) Required: T-30 Torx

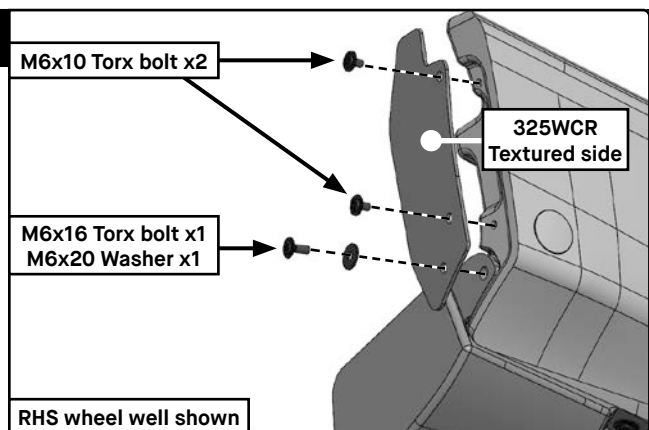

1.2
Remove underwing as shown.

Repeat on other side.

Tool(s) Required: T-30 & T-50 Torx

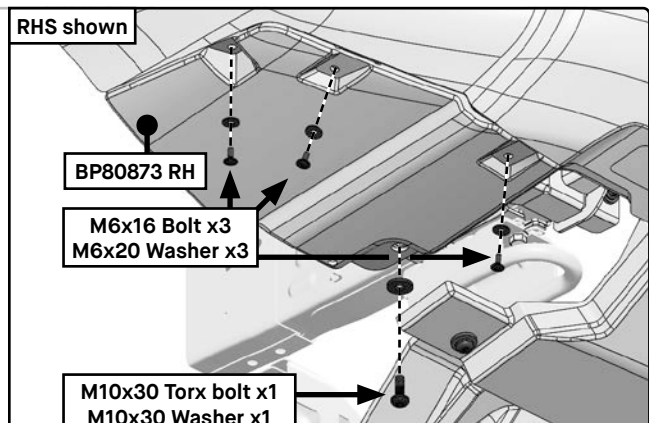

1.3

Unplug connector and remove hardware from light as shown.

Repeat on other side.

NOTE: Keep all hardware to refit.

Tool(s) Required: T-30 Torx

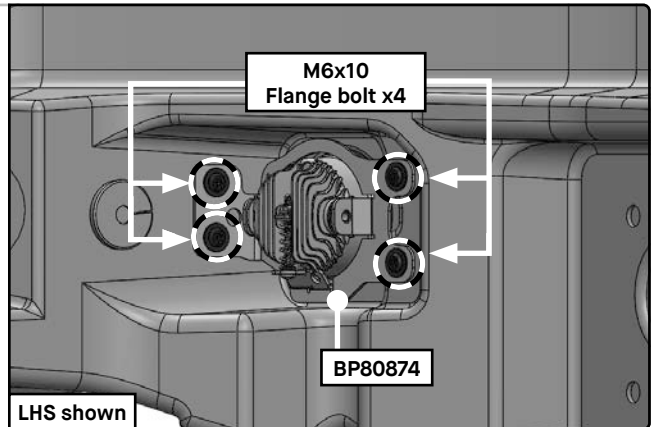

1.4

Unwrap new foglight and insert male connector to plug as shown.

Repeat on other side.

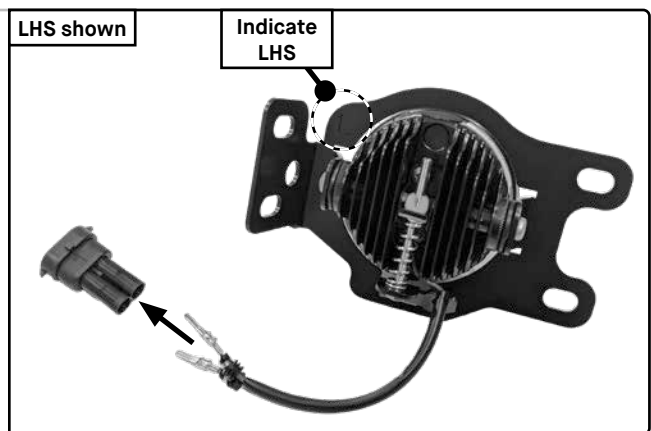

1.5

Fasten light assembly to bar as shown.

Ensure left light goes onto left side of bar and vice versa.

Repeat on other side.



M6 Fastener(s): **Max 5Nm**

Tool(s) Required: T-30 Torx

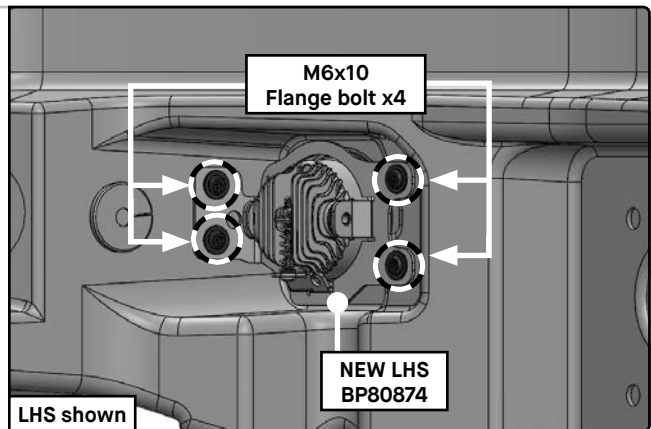

1.6

Tuck wheel arch liner behind underwing and secure to vehicle as shown.

Leave hardware loose.

Repeat on other side.

Tool(s) Required:
T-30 & T-50 Torx

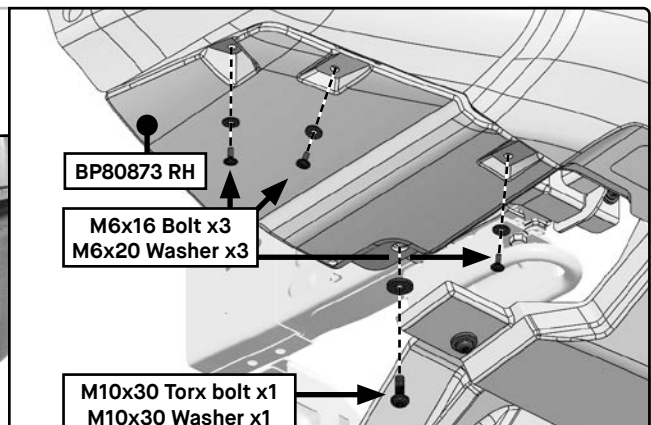
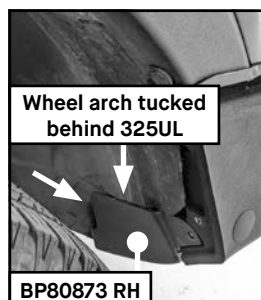

1.7

Install 325WCR plate behind wheel arch, using hardware shown.

NOTE: Ensure textured side is visible.

Repeat on other side with 325WCL.

Tool(s) Required: T-30 Torx

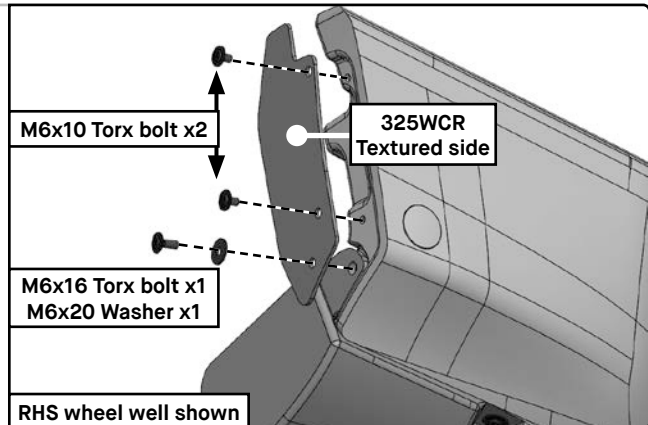
1.8

Tighten all hardware to the specific torque as shown.

Repeat on other side.



M6 Fastener(s) through plastic: **6Nm**
(Check tolerance **+0 / -2Nm**)

M10 Fastener(s) through plastic: **15Nm**
(Check tolerance **+0 / -3Nm**)

Tool(s) Required: T-30, T-50 Torx

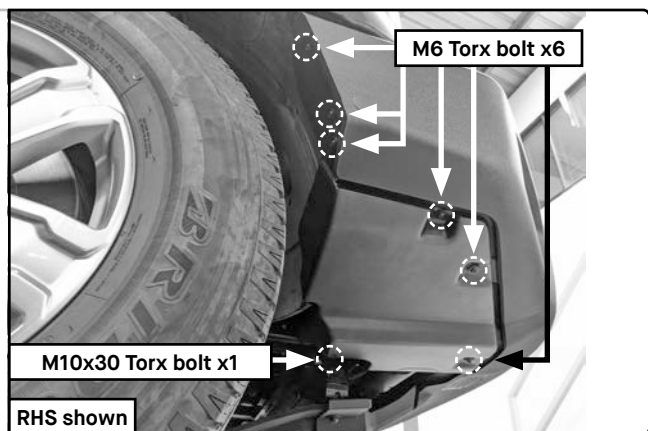
INSTALL COMPLETE - FITTED PRODUCT CHECKS

IMPORTANT CHECKS ONCE PARTS ARE REPLACED.

- Ensure all bolts are tensioned correctly.
- All wiring is clear of sharp edges or moving surfaces and is secured correctly.
- Check all wiring and connections to turn signal lamps, parking sensors, camera washers and any other functioning components that may have been altered during the installation.