

FITTING INSTRUCTIONS

DOCUMENT TITLE:

FI-TTW001

TUB TANK: Tub Mounted Water Tank

APPLICATION:

Ford Ranger 2022+

Suits all Ford Rangers with

ARB draw systems

*(Excluding PHEV models)***NOTE:** Does not fit with roller cover in place. Remove for fitment.**MODEL NUMBERS:**

TTW001FF

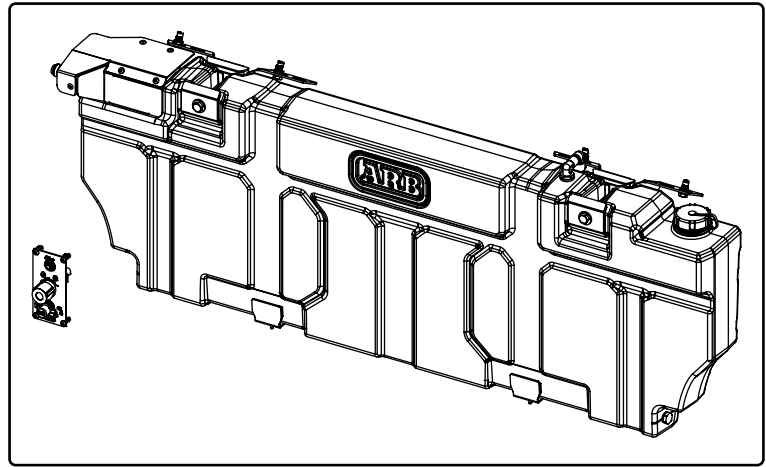
**FITTING TIME:**

Minimum 2.5 Hours

TTWLG - Additional 0.5 Hours

PUBLISHED DATE:

06 November 2025

ADDITIONAL KITS:

TTWLG - Water Level Guage

PROUDLY
AUSTRALIAN MADE

Congratulations on your purchase of a ARB Tub Tank.

**Anti-seize MUST be used on all threaded fittings into the Tub Tank.****Follow Torque Specifications detailed in table below and as outlined in instruction steps.****DO NOT OVERTIGHTEN FASTENERS.****NOTE:**

- REFER TO USER MANUAL PRIOR TO USE
- Do not use this product for any vehicle make or model, other than those specified.
- Do not modify the structure of the Tank in any way, unless otherwise instructed.
- Left and Right hand sides of the vehicle and Tub Tank throughout this instruction are from the view of Looking from the Rear of the vehicle.
- Front of Tub is Toward Front of Vehicle, Rear of Tub is toward Tailgate.
- Please take time to read the instructions before proceeding with fitment of the Tub Tank.
- Ensure all components, as listed in the bill of materials on the back page, are received prior to commencing the fitment. Please retain all hardware until fit-up is complete.
- Ensure these fitting instructions are passed onto the vehicle owner and/or operator.

TOOLS REQUIRED

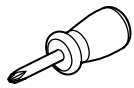

Phillips Head Screw Driver

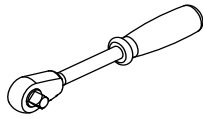

Socket Drive Torque Wrench (5-44Nm)

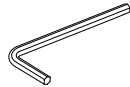

Allen Key 2, 3, 4, 6 mm

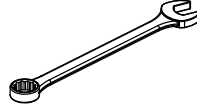

Ring Spanner 10, 13, 14, 16, 17, 22mm



Sockets 10, 13, 14, 16mm



Adjustable Spanner (Set at 28mm)



Tape Measure or Ruler

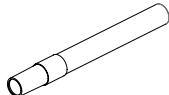

Marker Pen



Masking Tape

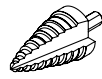

Step Drill Bit 10 - 20mm

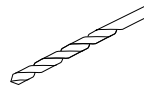

Drill Bit 5, 8, 11mm

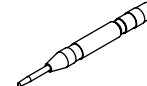

Centre Punch

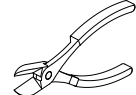

Side Cutters

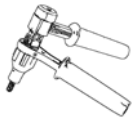

Rivnut / Nutsert Tool (Ratchet Type)



Jigsaw (Sheet metal blade)



Drill



Poly Tube Cutter



Threadlocker (Low/Med Strength)

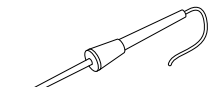

Soldering Iron

WATER TANK & MOUNTING BRACKETS OVERVIEW - TTW001 & TTW001BK

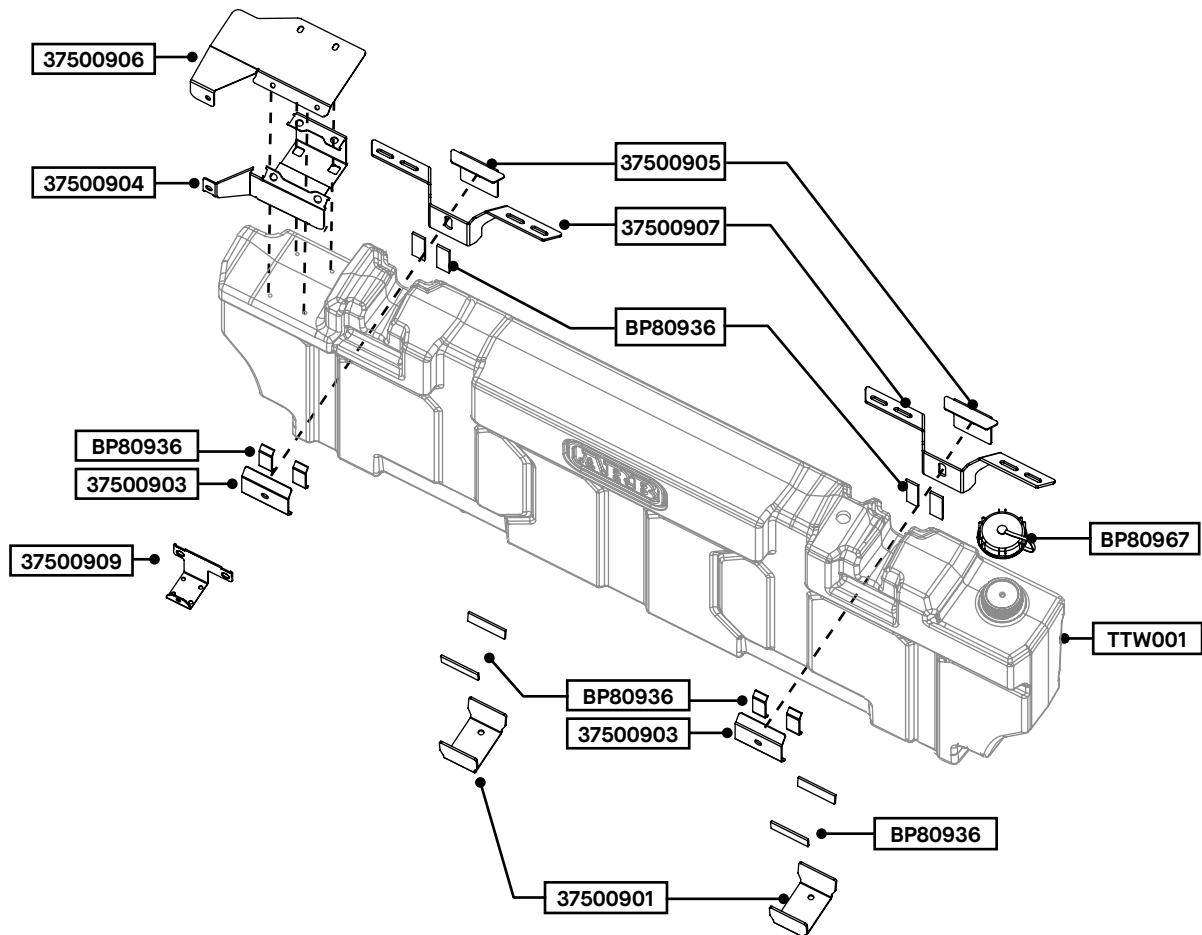

TTW001 HARDWARE KIT - ACCESS PANEL

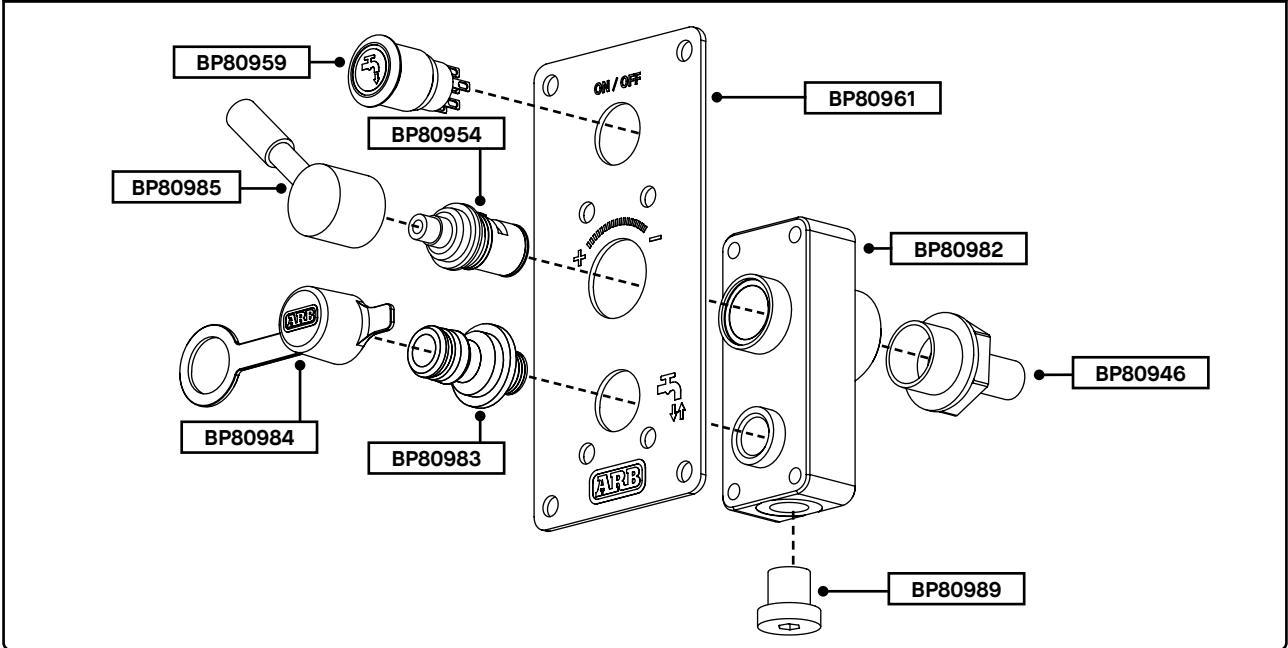

CONTENTS

STEP 1: BRACKET INSTALLATION Pg. 5

STEP 2: TANK ASSEMBLY Pg. 9

STEP 3: ACCESS PANEL ASSEMBLY Pg. 12

STEP 4: HARNESS INSTALLATION Pg. 16

STEP 5: TANK INSTALLATION Pg. 20

PACKING LIST Pg. 28

STEP 1: BRACKET INSTALLATION

1.1

Prepare tub and parts for fitment.

NOTE: Retain hardware and components until installation complete.

1.2

Install Rubber Pads (BP80936) to brackets as shown.

NOTE: Clean surface of bracket with isopropyl alcohol prior to sticking adhesive pad.

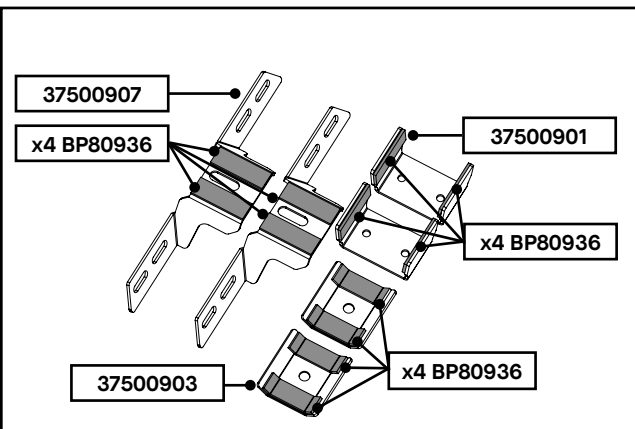

1.3

ARB Drawers Only:

Remove Left and right panels from back of drawers by twisting anti-clockwise.

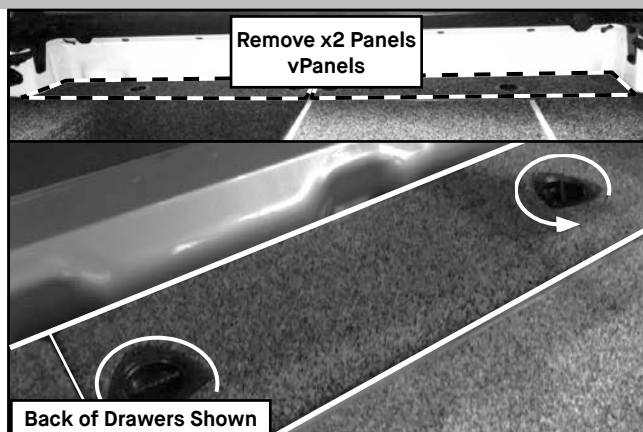

1.4

Remove 4 angled brackets from back of drawers by unscrewing M8 Bolts.

Reinstall M8 bolts to back of drawers once brackets removed.

Tool(s) Required: 13mm Socket, Electric Ratchet

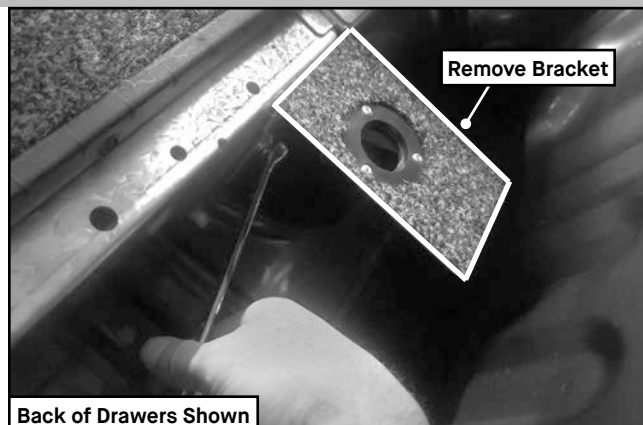

ARB DRAWERS ONLY

1.5

Locate x4 holes on headboard of tub.

Remove plugs from hole locations (if present).

Apply masking tape over holes and mark hole position with pen.

Tool(s) Required: Masking Tape, Pen

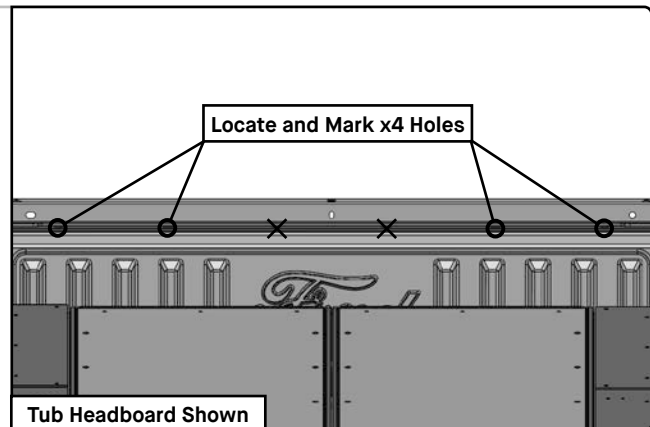
**1.5a****Tub Liner Variants Only:**

Pry tub liner away from tub and drill 18mm hole in tub liner at x4 above locations.

Tool(s) Required: Drill, Step Drill Bit

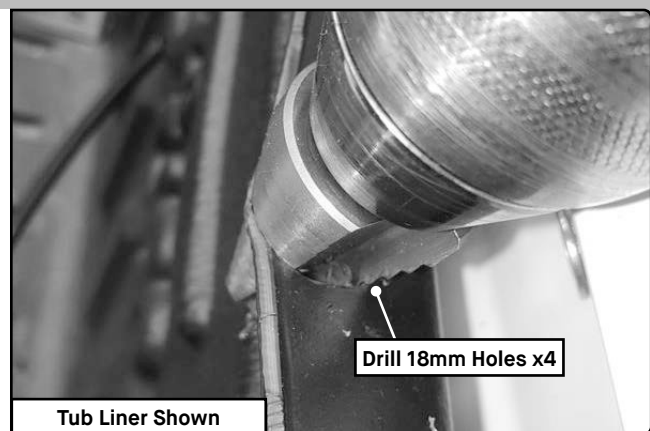
**1.6**

Drill x4 holes at marked positions to 11mm.

! WARNING: Use caution to avoid drilling through to cab.

Apply corrosion protection to exposed metal at edge of holes.

Tool(s) Required: Drill, 11mm Step Drill Bit

**1.7**

Install x4 M8 Nutsert into 11mm holes.

Tool(s) Required: Rivnut tool (Ratchet Type)

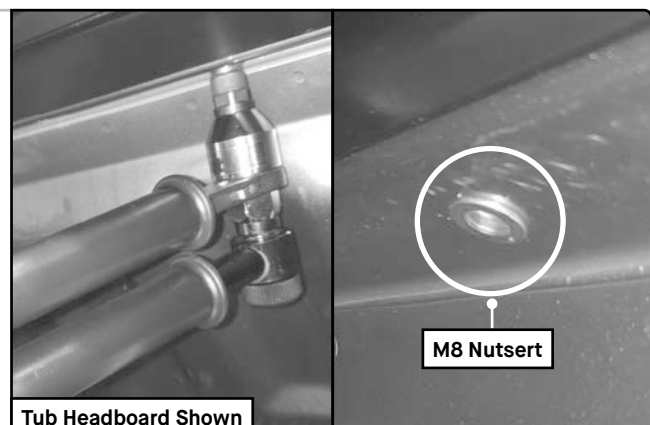

1.8

Install x2 Brackets (37500907) as per image using hardware as shown.

NOTE: Tighten finger tight.

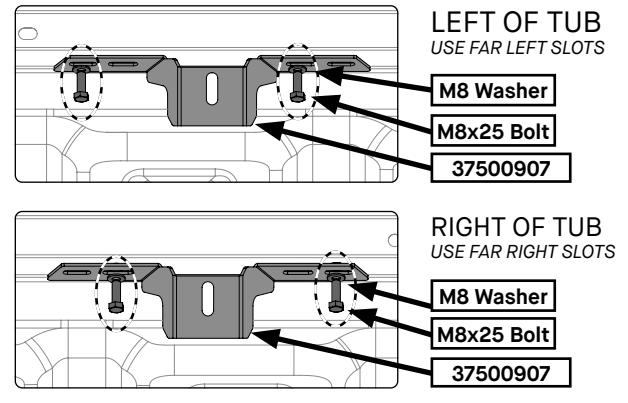
1.9
Bottom Bracket Position

Mark centreline of tub floor locate centre of rib 268mm either side of the centreline.

Apply x2 templates to floor as per instructions.

Tool(s) Required: Marker, Tape Measure

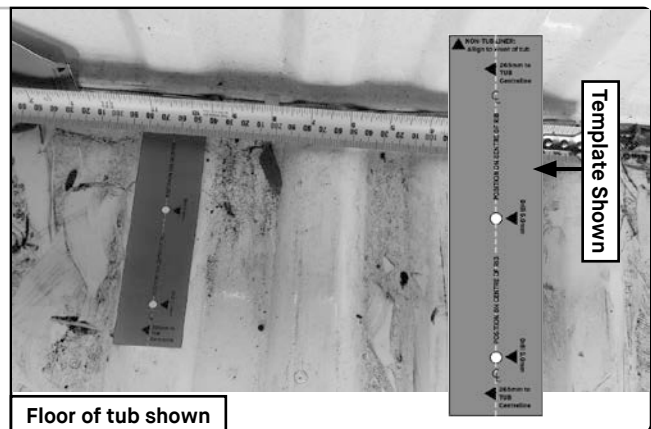

1.9a If Tub Liner Fitted:

Refer to template to mark bottom bracket hole positions.

Use centre punch at marked hole locations (as per template) and drill x4 5mm holes.

Apply corrosion protection to exposed metal at edge of holes.

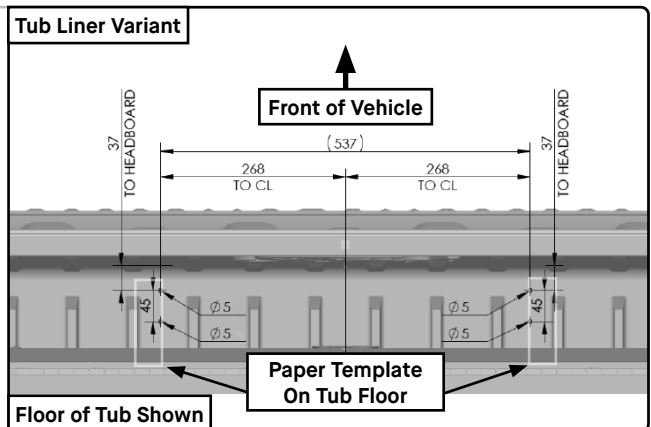
Tool(s) Required: Drill, 5mm bit



1.9b If No Tub Liner Fitted:

Refer to template to mark bottom bracket hole positions.

Use centre punch at marked hole locations (as per template) and drill x4 5mm holes.

Apply corrosion protection to exposed metal at edge of holes.

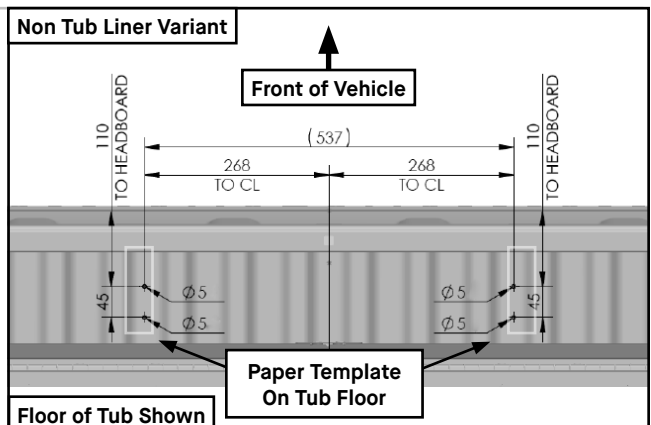
Tool(s) Required: Drill, 5mm bit



1.10

Install Bottom Brackets

Install Brackets using hardware as shown.

Repeat other side.

Bottom Brackets Installed.

Tool(s) Required: Rivet Gun

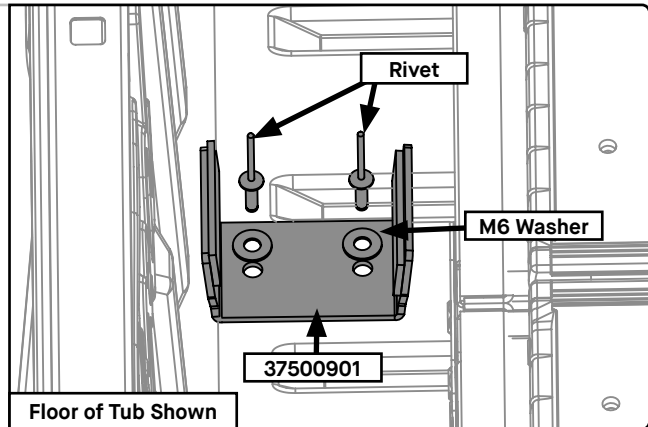

1.11

Bottom Brackets installed.

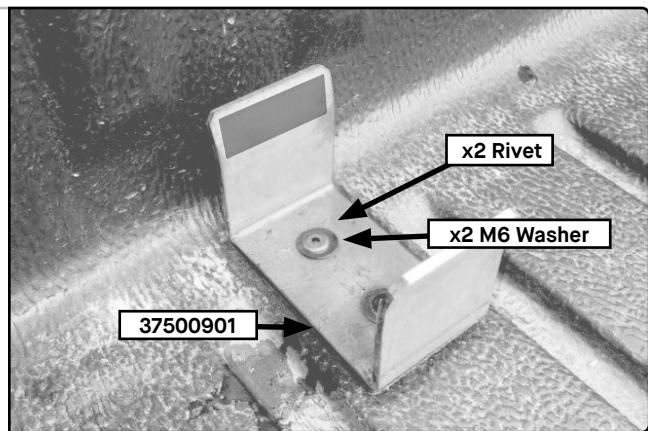

1.12

Tub liner variants only:

Measure 40mm from base of tub.

At bottom Left Back Corner of tub measure and drill 20mm hole in tub liner as shown.

Repeat other side of Tub.

Tool(s) Required: Drill, 20mm Step Drill Bit, Tape Measure

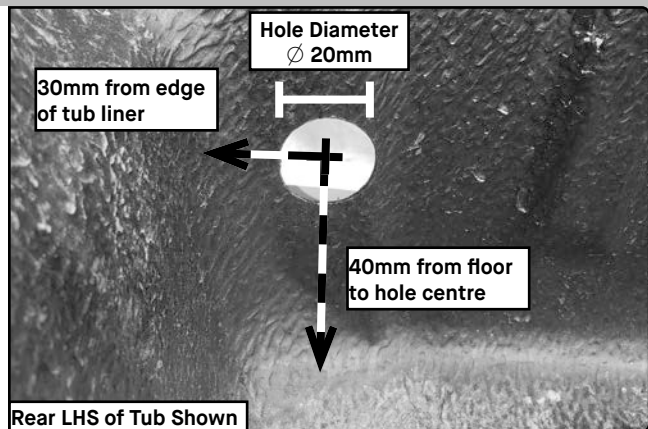

1.13

Vacuum bottom of tub thoroughly to clear any swarf from drilling.

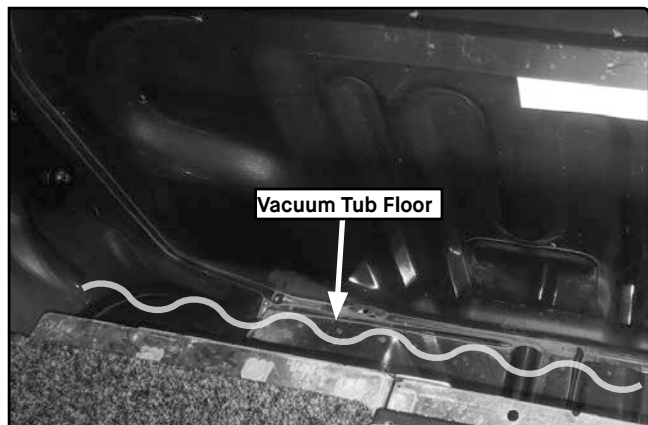

STEP 2: TANK ASSEMBLY
**2.1
Prepare Pump**

Install fittings as shown.

Press hardware into pump feet as shown.

Tool(s) Required: Adjustable Spanner (1")

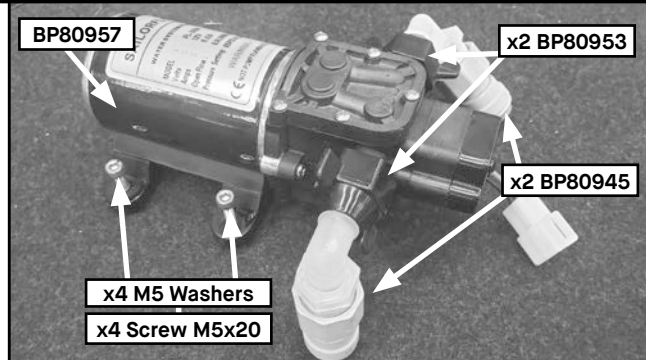
2.2
Prepare Pump Bracket

Press x5, M6 U Nuts (6151475) onto Pump Bracket until click is heard.

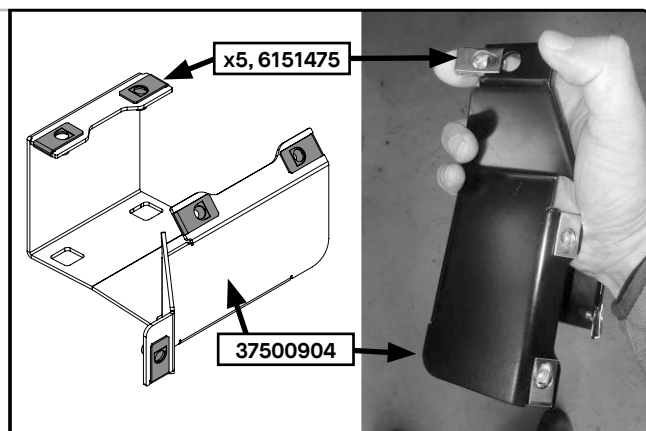

2.3
Install Water Pump (MUST USE ANTISIEZE)

Fasten Water Pump and Water Pump Bracket to M5 inserts in Water Tank.

NOTE: Ensure bracket alignment is straight before tightening fasteners.

M5 Fastener(s): **6Nm**

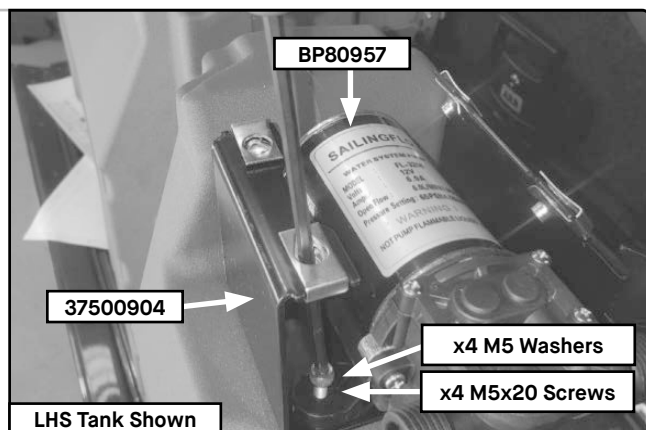
Tool(s) Required: 4mm Allen Key, Torque Wrench, Antisieze

2.4
Install Pump Cover

Fasten Pump Cover (37500906) to Pump Bracket (37500904) using hardware shown.

M6 Fastener(s): **9Nm.**

Tool(s) Required: 4mm Allen Key, Torque wrench

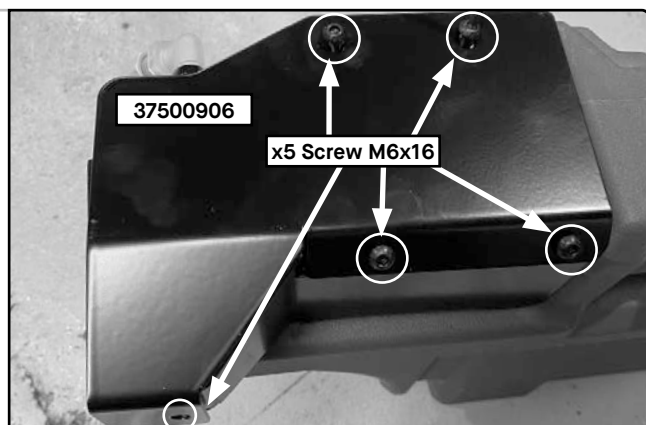

JOHN GUEST INSTALLATION GUIDE

2.5a

Prepare the hose

Ensure the hose is free of score marks.

Cut hose square.

NOTE: Hose Cutters are recommended to achieve a square, clean cut.



2.5b

Push hose up to Hose Stop

Push pipe into fitting, to pipe stop.

⚠ WARNING: If hose is not against stop, it will leak.

Pull To Check Secure

Pull on hose to check it is secure.

Test system before use.

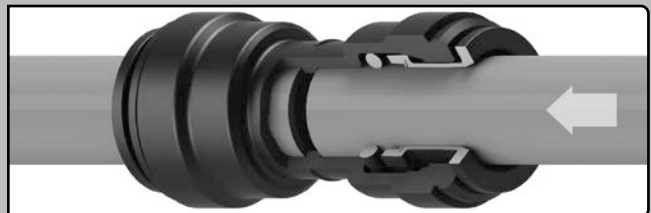

2.5c

⚠ DO NOT:

Do not use damaged or scored hose. Score marks can cause leaks past O-Ring.

⚠ DO NOT:

Do not use hacksaws to cut hose or leave burrs on end of hose.

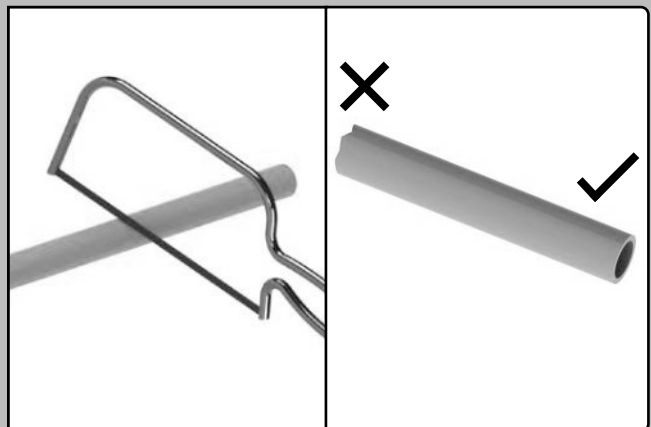

2.5d

How To Disconnect

To disconnect, ensure system is depressurised.

Push collet square against the fitting. With collet held in this position, hose can be removed.



2.6

Cut hose to lengths as shown.

Join Tank outlet/inlet to water pump as shown.

Ensure fittings are tightened and pipe is pushed against stop.

Tool(s) Required: 1" Spanner, Hose Cutter

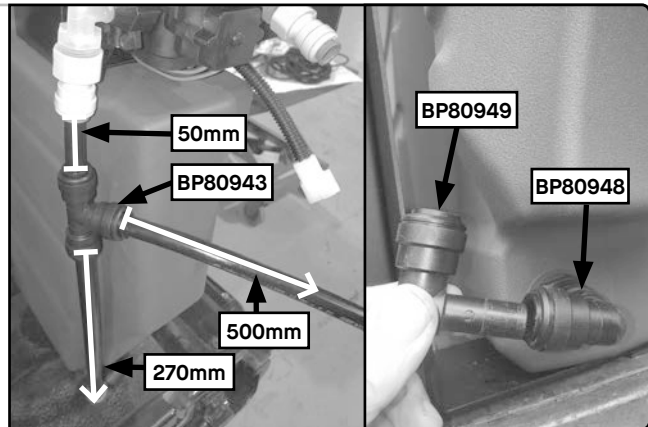
**2.7**

Remove Bung from top of tank.

Install Overflow fitting (BP80991) to 1/2" BSP Threaded insert at top of tank.

 **IMPORTANT: DO NOT OVERTIGHTEN**

Tool(s) Required: 22mm Spanner

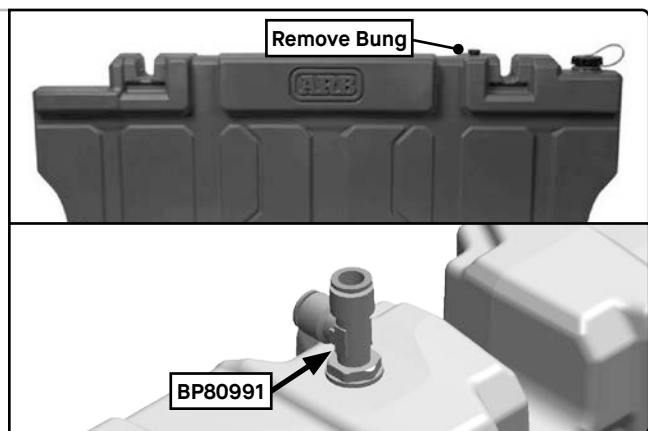
**2.8**

Add 5-10l of water to tank and check for leaks.

Adjust fittings if necessary and drain water.

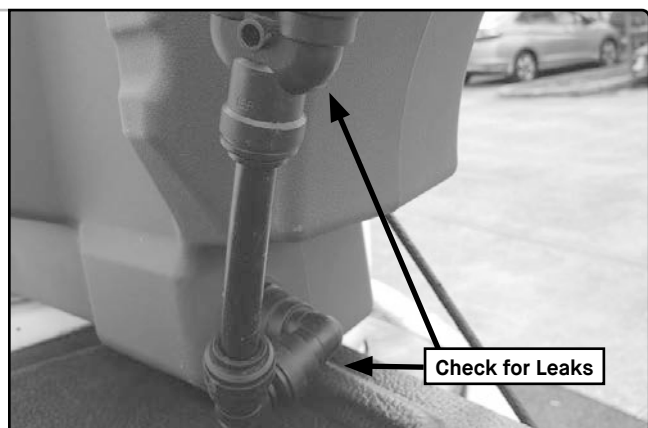

STEP 3: ACCESS PANEL ASSEMBLY & INSTALLATION
3.1

Fasten Panel (BP80961) to Manifold (BP80982) with hardware shown.

M6 Fastener(s): **5Nm.**

IMPORTANT: DO NOT OVERTIGHTEN

Tool(s) Required: 4mm Allen Key, Torque wrench

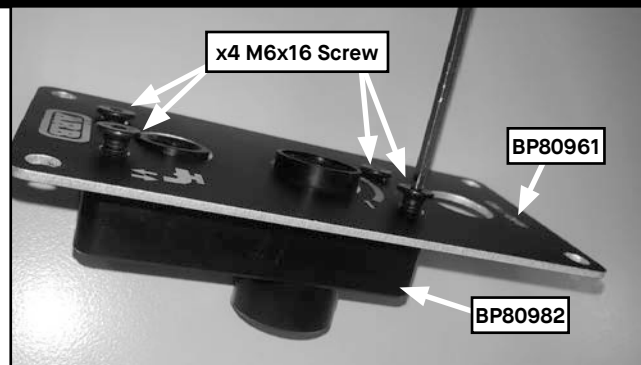
3.2

Install 12V Switch to panel. Align switch as shown and tighten lock nut.

Tool(s) Required: 22mm Spanner

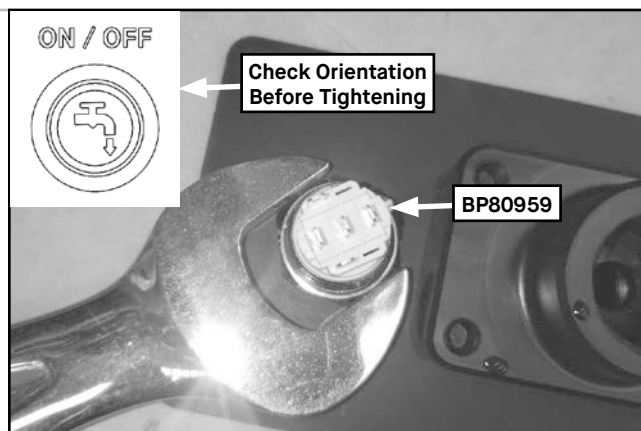
3.3

Install Tap Cartridge (BP80954).

Tap Cartridge(s): **6Nm.**

IMPORTANT: DO NOT OVERTIGHTEN

Tool(s) Required: 14mm Socket, Torque Wrench



3.4

Press Dust Cap onto Manifold. Install Hose Connector to Manifold.

Hose Connector: **6Nm.**

IMPORTANT: Do not overtighten.

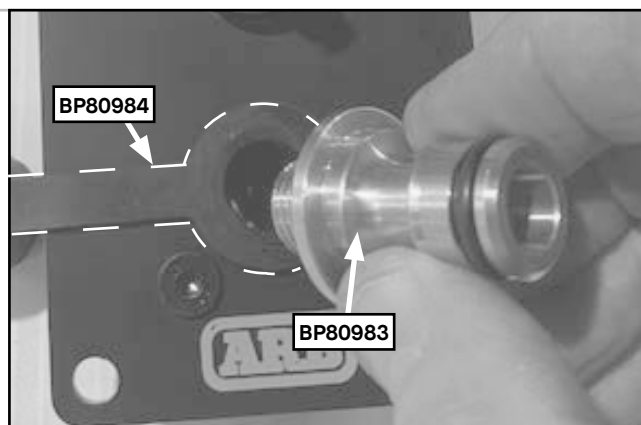
Tool(s) Required: 18mm Spanner



3.5

Confirm tap cartridge spindle is fully open or closed, remove handle from spindle, Loosen grub screw in body, leave in place.

Place Handle onto Cartridge spindle.

Confirm grub screw position lines up with '+ -' indicators when tap position 'on/ off'.

Press firmly on handle body to engage handle into spline.

Tool(s) Required: Allen Key 2mm

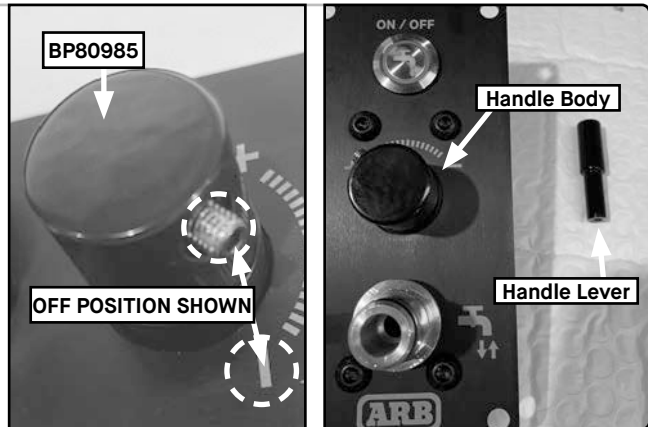

3.6

Remove grub screw, apply threadlocker to grub screw and install into handle body.

Tighten grub screw.

Install Handle Lever and tighten.

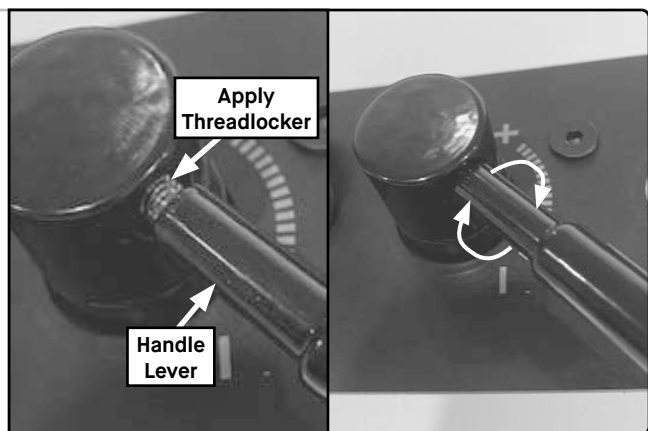
Tool(s) Required: Allen Key 2mm, Threadlocker (non-permanent)



3.7

Install 1/4" BSP Bung into Manifold.

Bung: 6Nm.

IMPORTANT: DO NOT OVERTIGHTEN

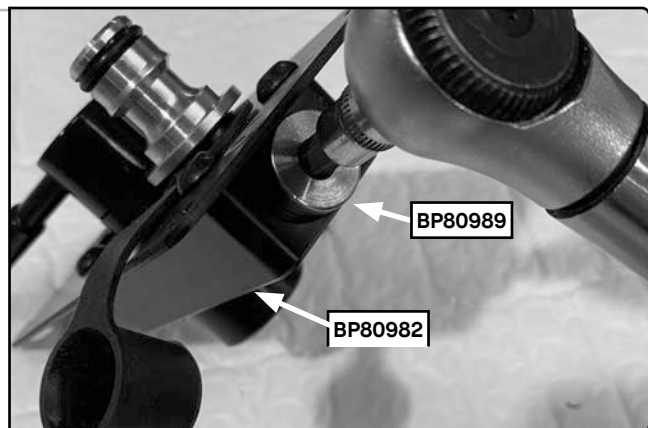
Tool(s) Required: 6mm Allen Key, Torque wrench

3.8

Install JG 1/2" BSP Stem Fitting to back of access panel as shown.

Access Panel Assembly Complete.

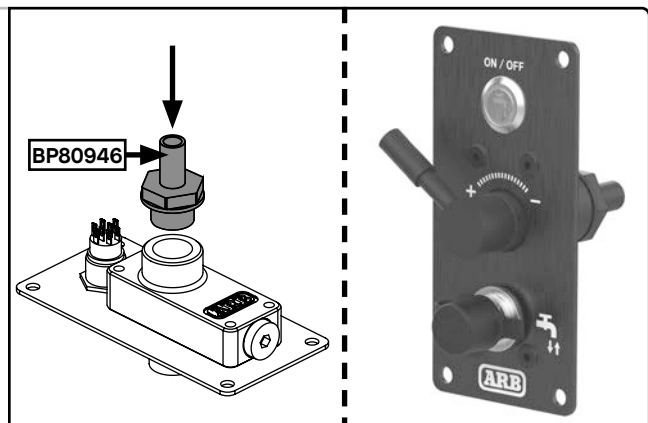

3.9 Access Panel Drawer Wing Fitment:

Remove side cover from drawers to gain access to rear of drawer wing.

NOTE: If accessories are installed in drawer wing area, cover with protective cloth.

NOTE: If fitting drawers at same time as TUB TANK, complete the below steps before installing drawer wings.



LHS Drawer Wing Shown

3.10

Align Template with LHS panel as per instructions on template.
Mark trim lines and hole centres.

NOTE: If installing water level guage, follow instructions as per template.

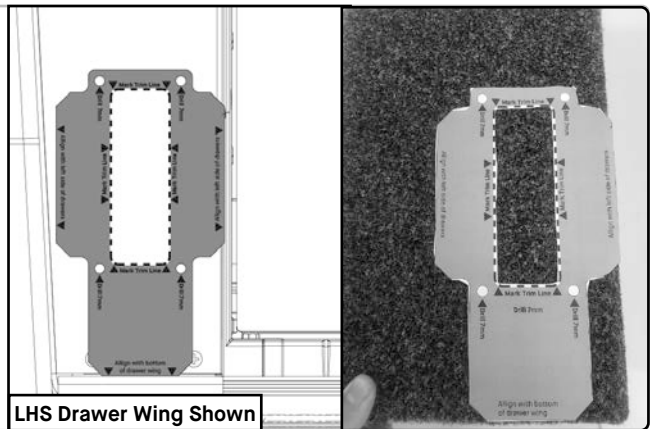

LHS Drawer Wing Shown

3.11

Use centre punch at x8 marked locations as per template.

Tool(s) Required: Centre Punch

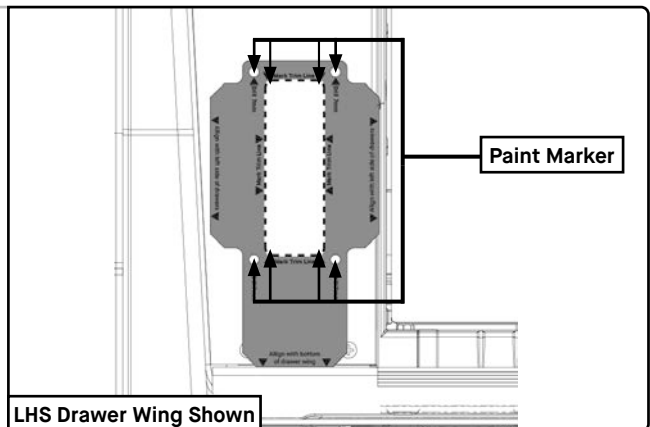

LHS Drawer Wing Shown

3.12

Drill x4 outside holes to 8mm as per template.

Tool(s) Required: Drill, 8mm Bit (Steel)

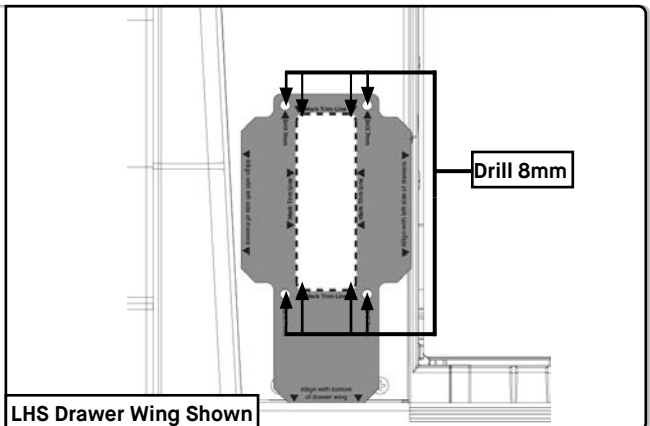

LHS Drawer Wing Shown

3.13

Use Airsaw or jigsaw to cut out centre as per template.

Apply corrosion protection to edges of sheet-metal after cutting.

If installing water level guage, repeat steps 3.10 to 3.13 as per template.

Tool(s) Required: Airsaw, sheet metal cutting blade



LHS Drawer Wing Shown

3.14

Fit Access Panel to drawer wing as shown using hardware as shown.

NOTE: Water level guage is installed at a later step.

Do Not over tighten as panel with pull

Tool(s) Required: 4mm Allen Key, 10mm Socket

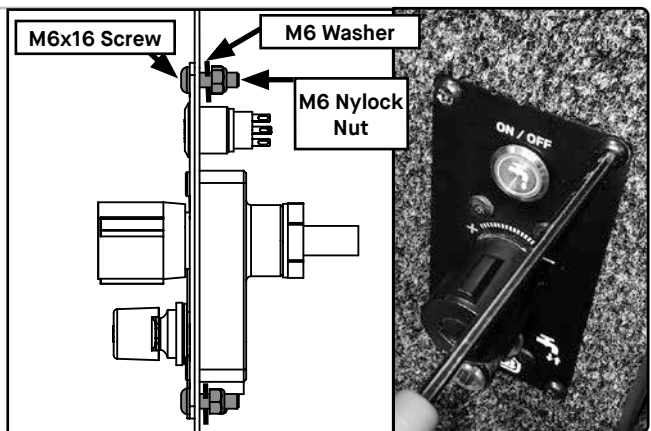

3.15

Thoroughly vacuum any swarf.

Access Panel now installed.



STEP 4: HARNESS INSTALLATION

4.1

If not installing water level guage, skip to step 4.9.



4.2

Open TTWLG and assess contents as shown.



TTWLG Kit Shown

4.3

Wiring Installation

Remove tape from yellow switch connector end of harness.

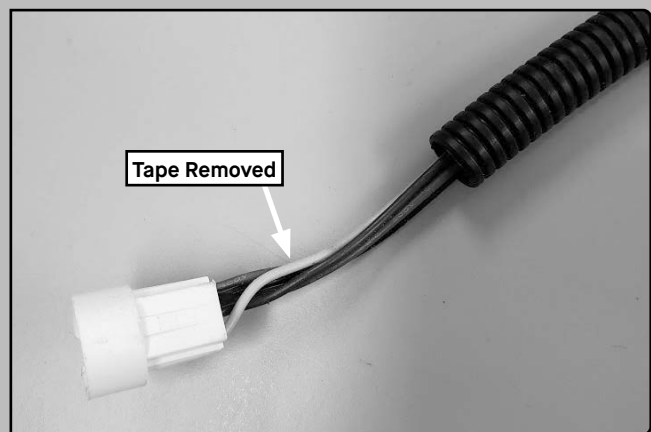

TTWLG ONLY

4.4

Strip back black and red wire, minimum 70mm away from yellow connector, as shown.

USE CAUTION NOT TO SLICE WIRE STRANDS

Tool(s) Required: Cutting Blade

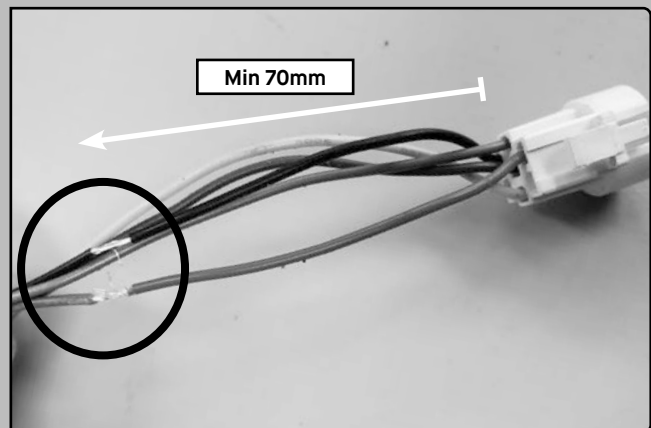

4.5

Cut Topargee Gauge power wire to desired length.

Strip red and black wire to expose approx. 15mm bare wire.

Tool(s) Required: Wire Strippers

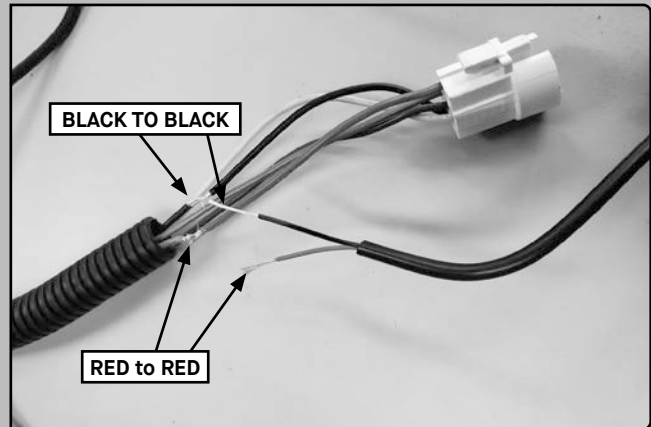
**4.6**

Wrap Topargee red and black wires around stripped back red and black harness wires.

Solder wires and wrap with electrical tape.

Tool(s) Required: Soldering Iron

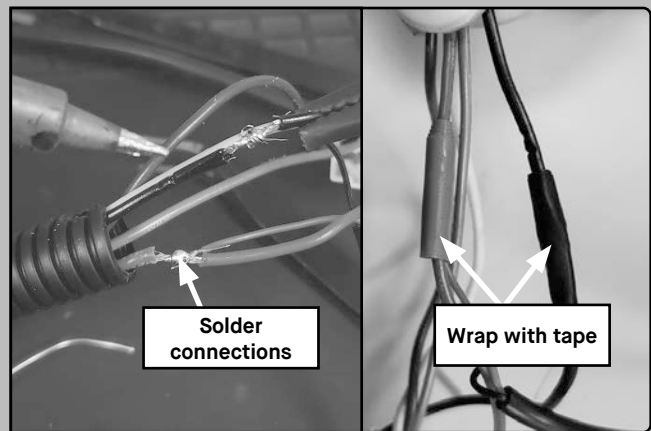
**4.7**

Refit conduit and finish with tape.

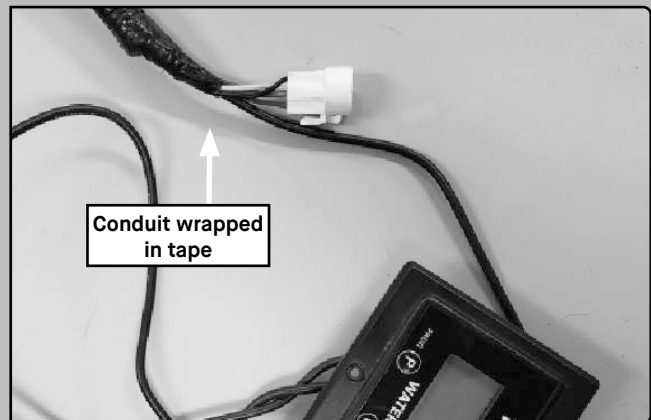
**4.8**

Install LCD Display to drawer wing using instructions supplied with water level gauge.

Complete instructions as normal.



TTWLG ONLY

4.9

Push +12V red eyelet and fuse holder through left grommet in tub, feed toward left chassis rail (passenger side).

Push harness (BP80960) through 20mm hole previously drilled.

TUB LINER ONLY: Fuse holder will need to be disconnected as shown on right.

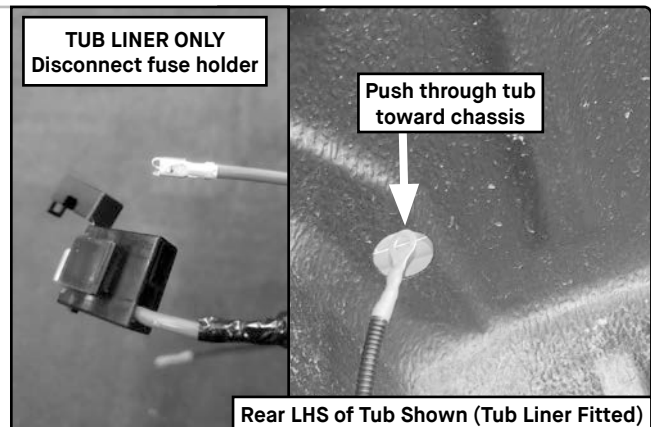
**4.10**

Run 12V power lead along chassis toward primary or secondary battery.

Secure wire to chassis rail/ body of vehicle with supplied cable ties.

NOTE: Secondary battery preferred.

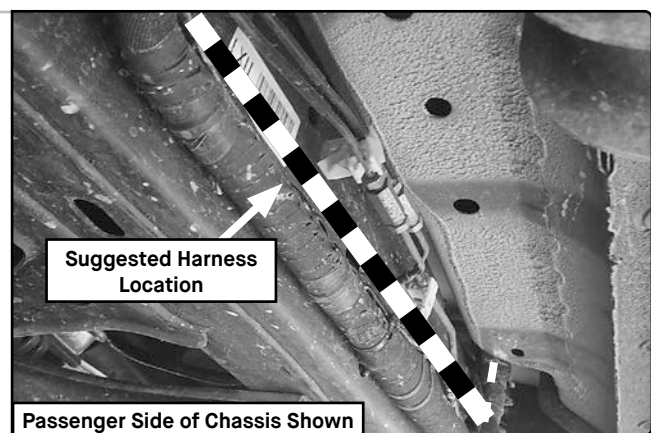
**4.11**

Remove 10A fuse from Harness (BP80960) and put aside.

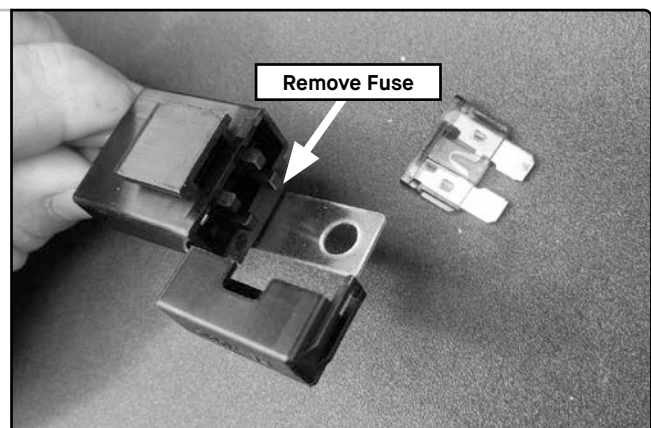
**4.12**

Run wire up firewall towards battery.

Connect red ring terminal to positive battery terminal as shown.

Secure fuse holder to body of vehicle using supplied self tapping screw.

NOTE: Use second battery if present.

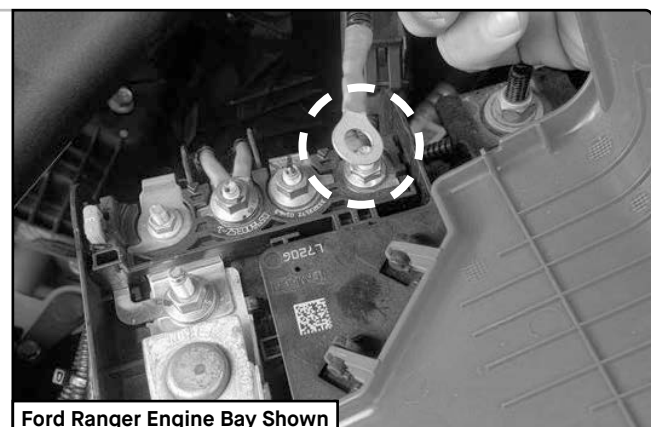

4.13

Attach ground wire to Tub body at tie down point.

NOTE: Use any other ground post if available.

Remaining harness installation to follow after tank installation. Harness to follow path of hose to access panel.

STEP 5: TANK INSTALLATION

5.1

Assemble Overflow fittings as shown.
Trim Hose to the following dimensions.

- B1 = 380mm
- B2 = 400mm
- B3 = 250mm

Tool(s) Required: Tube Cutter

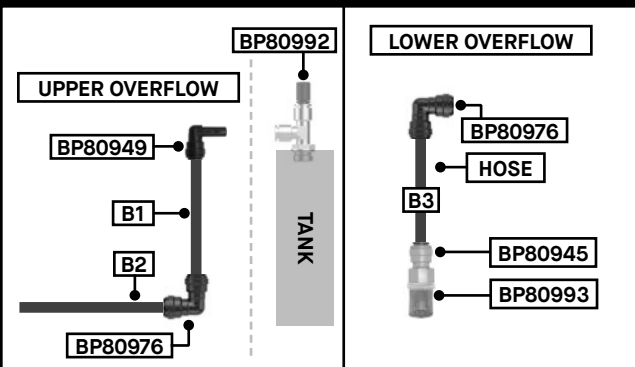

5.2

Place **Upper Overflow** fittings into bottom corner of tub at front of tub.

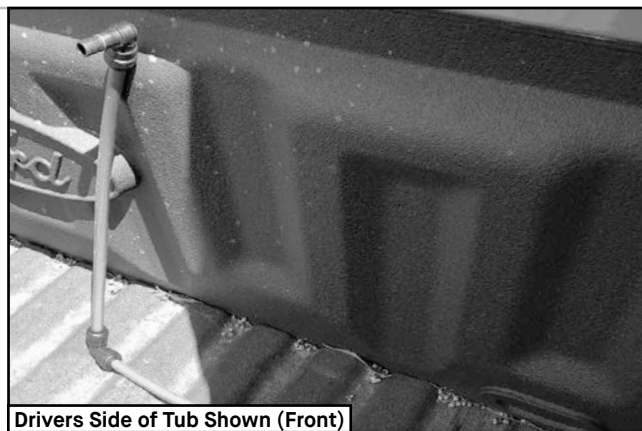

Drivers Side of Tub Shown (Front)

5.3

Retain **Lower Overflow** fittings between tub and cab on drivers side of vehicle.

Remove scrivenets from front of wheel guard to gain access to space between cab and tub.

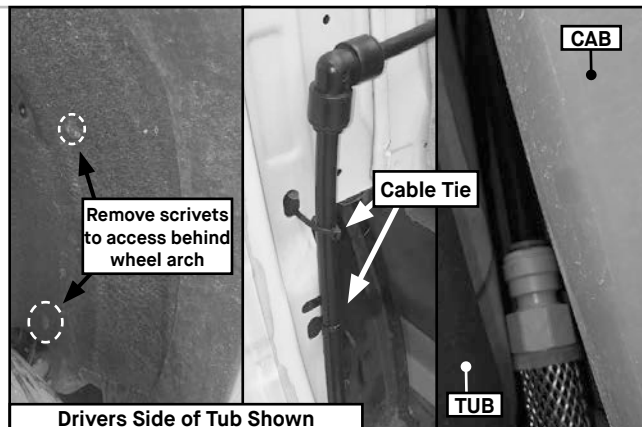

Drivers Side of Tub Shown

5.4

Prepare Solenoid Bracket as shown.

Push x2 M6 U Nut onto Solenoid Bracket until click is heard.

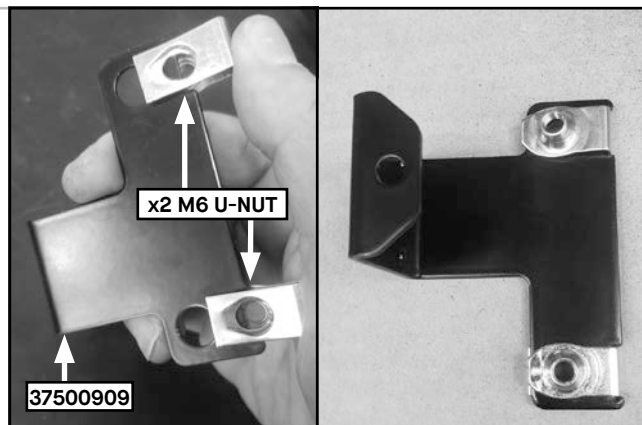

5.5

Fit JG Fitting to both ends of Solenoid.

Tighten with 1" spanner.

Tools Required: 1" Spanner

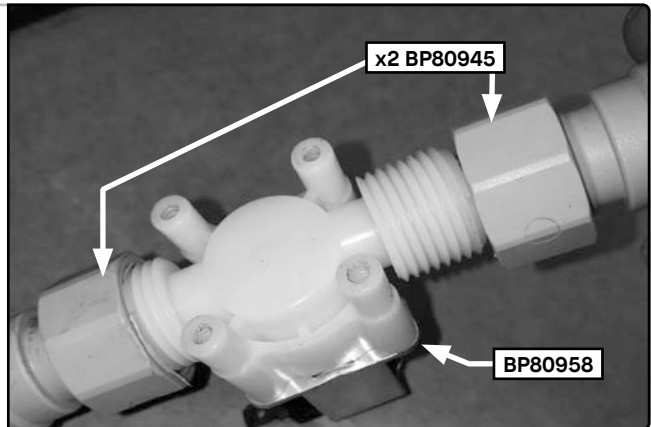
**5.6**

Fasten Solenoid (BP80958) to Solenoid Bracket (37500909) using hardware shown.

NOTE: Ensure correct arrow orientation on Solenoid as shown.

Tool(s) Required: Philips Head Screwdriver

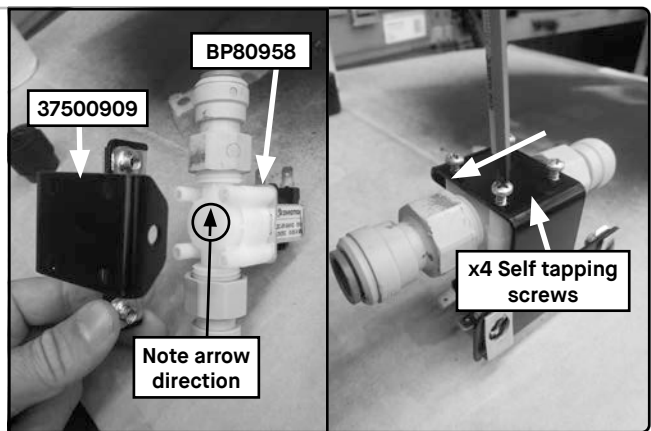
**5.7**

In front LHS of vehicle tub, connect Harness to Solenoid as shown.

NOTE:

- Solenoid is not polarity sensitive.
- Ensure connectors fully engaged.

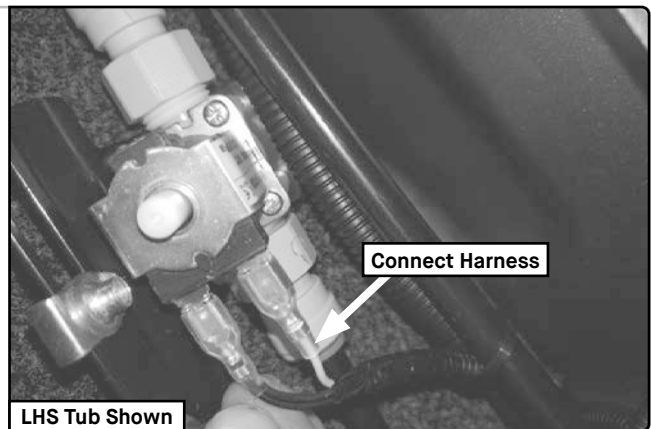
**5.8**

Connect hose from JG 12mm Tee (BP80943) to Solenoid.

Cut 12mm Tube to suitable length.

NOTE: Refer to step 5.14 for system overview.

Tool(s) Required: JG Tube Cutter

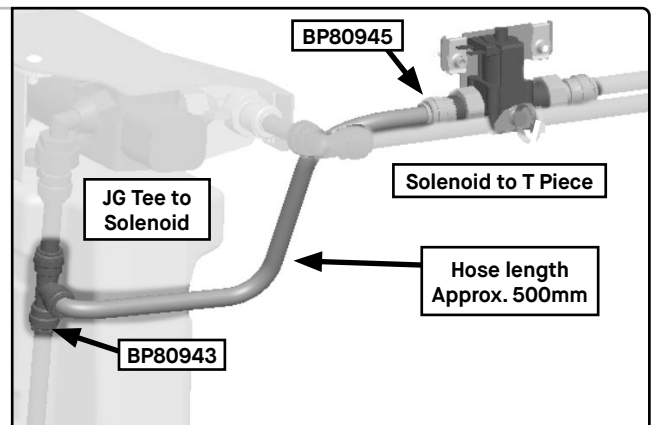

5.9

Place Tank in tub of vehicle and connect Harness to Water Pump.

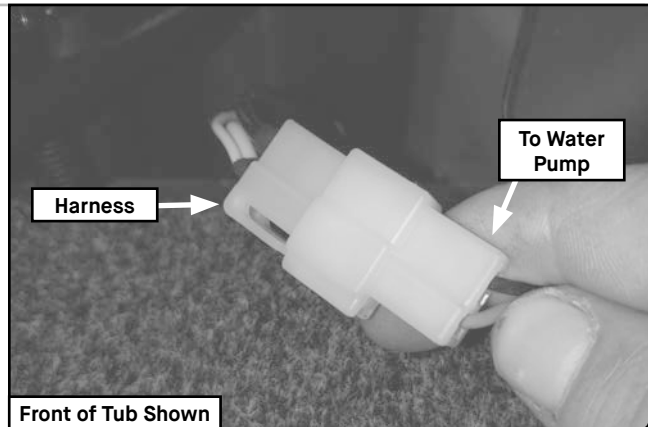

Front of Tub Shown

5.10

Insert Tank into cavity, ensuring tank is seated on floor of tub.

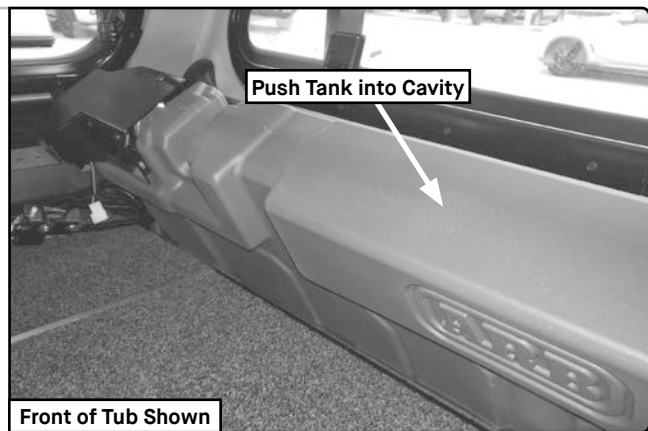

Front of Tub Shown

5.11

Connect upper overflow tube to tee fitting(bp80991) in tank.

Press Vent (BP80992) into top of tee.

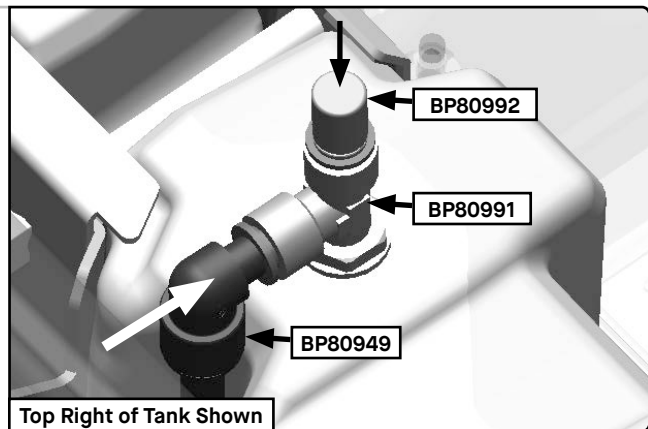

Top Right of Tank Shown

5.12

Install Tank Brackets

Position 37500905 at rear of tank.
Repeat other side of tank.

NOTE: Use caution not to drop 37500905 TT common rear bracket or tank will need to come out to recover.

Front Tank Brackets: **8Nm.**

Tool(s) Required: 16mm Socket, Torque Wrench

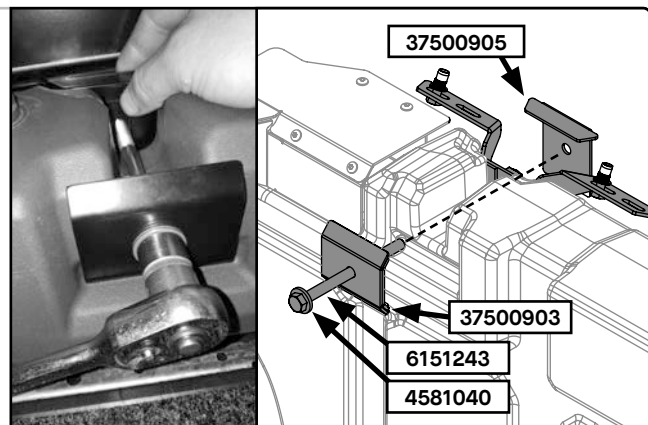

5.13

Tighten x2 M8 Fasteners as shown.

Repeat other side of tank.

Tool(s) Required: 13mm Spanner

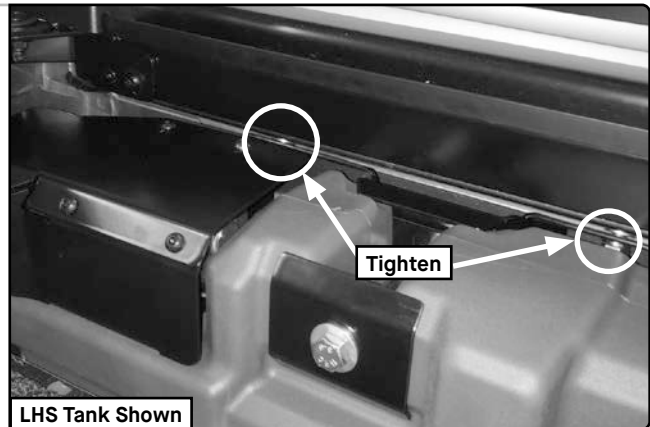

LHS Tank Shown

5.14

Join Hoses as shown:

Trim JG 12mm Hose to the below lengths.

- | | |
|-----------|-----------|
| H1: 120mm | H6: 500mm |
| H2: 250mm | H7: 80mm |
| H3: 880mm | H8: 80mm |
| H4: 280mm | H9: 250mm |
| H5: 80mm | |

- Connect **H6** to 'Solenoid' (trim hose length if necessary).
- Connect **H7** to Water Pump outlet.
- Connect JG Elbow to **H7**
- Connect **H4** From **H7** to 'JG Equal Divider.'
- Connect **H5** from solenoid to 'JG Equal Divider'
- Connect **H3** to JG Elbow

Check hoses are connected as shown.

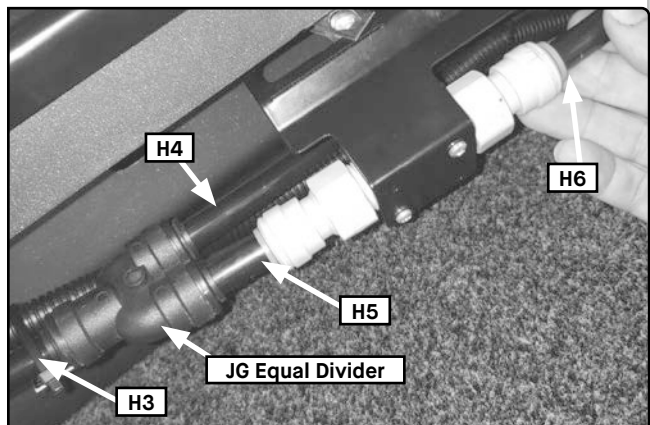
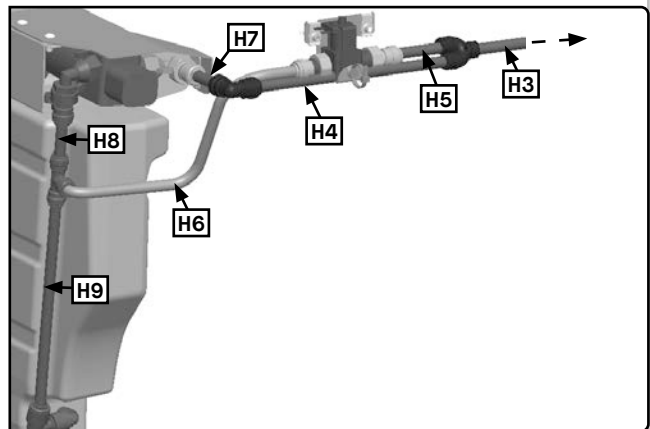
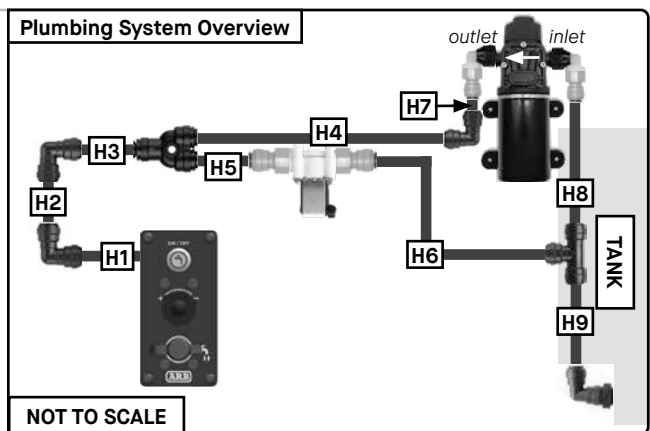

Check hoses are connected as shown.

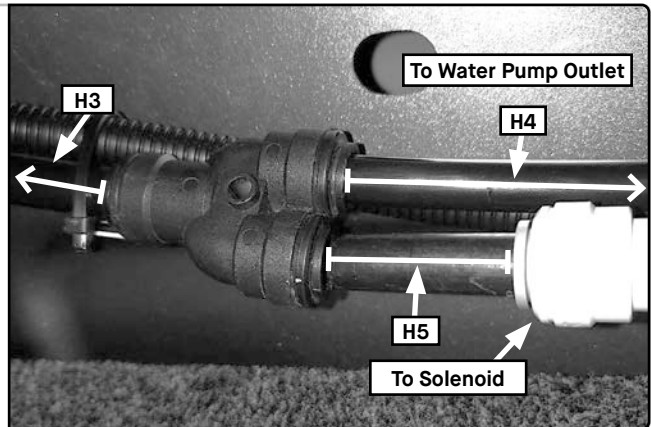

5.15

Fasten solenoid bracket to tub as shown using hardware as shown.



Solenoid Bracket: **9Nm**.

Tool(s) Required: 4mm Allen Key

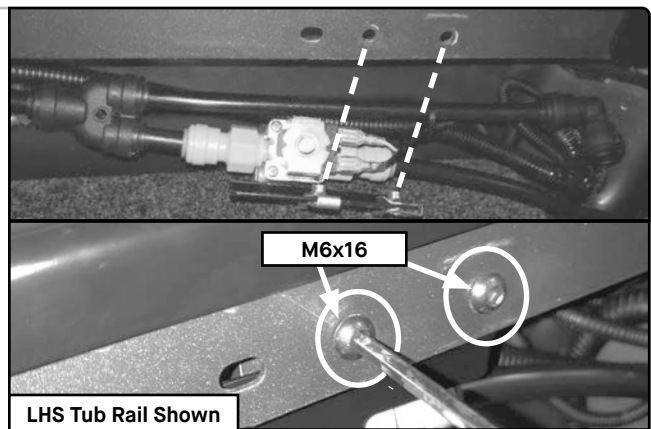

5.16

If **not** installing Topargee water level gauge, skip to step 5.18.

Install x2 fittings to sender and tighten.

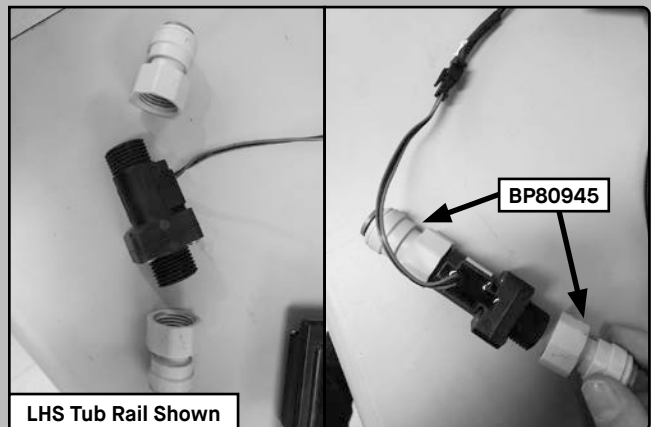

5.17

Cut 80mm from centre of **H3**.

Connect sender inline with **H3**.

Connect +12V plug to sensor.

Position under rail near tailgate.

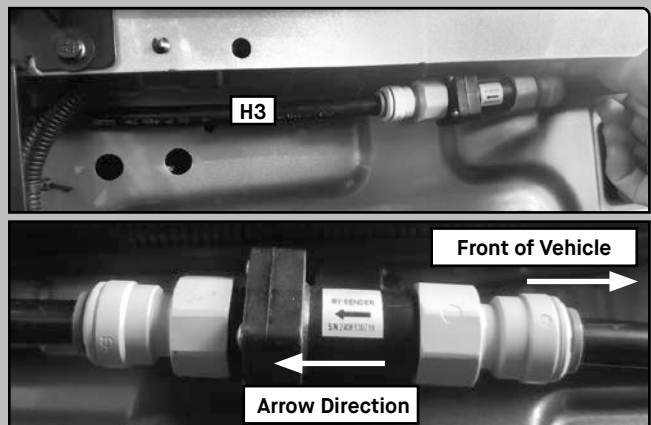

TTWLG ONLY

5.18
Harness Routing to follow hose (H1-H4) path towards access panel.

Use Adhesive Cable tie pad and cable ties to fasten harness and hose under tub rail at x5 locations.

NOTE: Clean surface with isopropyl alcohol before sticking to tub.

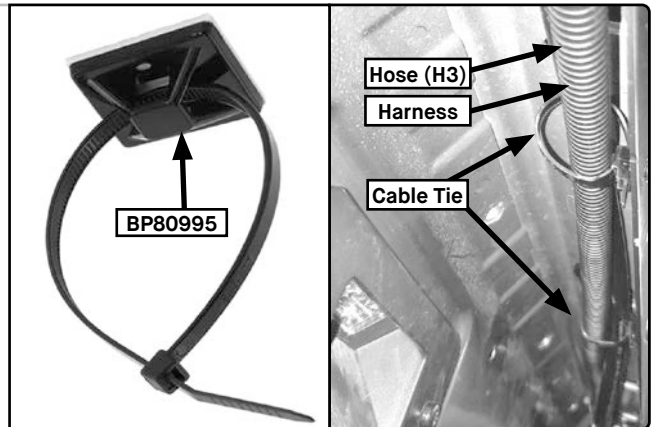

5.19
 Connect JG Elbow to **H2** and **H3**.

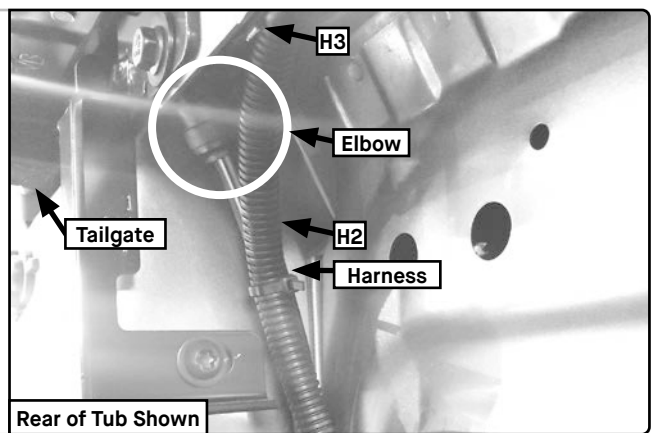

5.20
Connect to Access Panel
 Connect Harness to rear of switch on access panel.

Connect fitting and hose to access panel as shown.

Hoses and harness are now connected.

Re-Install side cover to side wing.4



5.21
 Reinsert 10A fuse.

Place OWNERS MANUAL in glove box of vehicle.

INSTALLATION IS NOW COMPLETE.

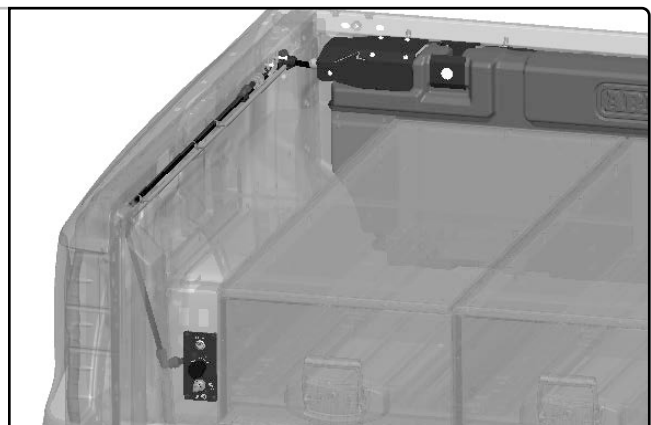

INSTALL COMPLETE

 Important checks once the Water Tank is fitted.

- Ensure all bolts are tensioned correctly.
- Ensure all fittings are correctly tightened, are leak free, pushfit fittings installed correctly.
- All wiring is clear of sharp edges or moving surfaces and correctly secured.

Tub Tank Operation Testing Procedure:

- 1.1 Check Pump powers on and switch illuminates
- 1.2 Fill Tank with clean drinking water. Check top hose connections.
- 1.3 Power on pump and check flow of water.
- 1.4 Check for any leaks and adjust fittings as required.
- 1.5 If flow is poor or unstable, or pump fails to prime - Refer to OWNERS MANUAL for troubleshooting procedure.



TTW001FF			
Code	Description	Qty	OK
TTW001ASSY	TTW001 RANGER ASSY	1	
TTW001BK	TTW001 BRACKET KIT	1	
TTHWKA	TTWKA HARDWARE KIT	1	
TTHWKBOX1	TTWK BOX 1	1	
TTHWKBOX2	TTWK BOX 2	1	
BP80942	JG 12MM TUBE BLACK	4m	
BP1191	56404 CABLE TIES (100)	1	
BP80960	WIRING LOOM	1	
FI-TTW001-A	RANGER FITTING INSTRUCTIONS	1	
TT-TTW001-A3-A	RANGER TRIM TEMPLATE	1	
OM-TTW-A5-A	TUB TANK OWNERS MANUAL	1	
Packed By		Date	

TTW001BK - TTW001 BRACKET KIT			
Code	Description	Qty	OK
TTW001BKA	TTW001 BRACKET KIT BOXED	1	
SEPARATE BAG			
BP80936	ADHESIVE RUBBER PAD	12	
6151243	BOLT M10x1.5x130	2	
4581040	WASHER FLAT M10x25x3	2	
6151022	BOLT M8x1.25x25	4	
4581044	WASHER FLAT M8x17x1.6	4	
6152273	NUTSERT M8x1.25	4	
6609087	RIVET 3/16 DIA 4.8-11.1	4	
BP80607	PLASTIC BAG 400 X300X100	1	
Packed By		Date	

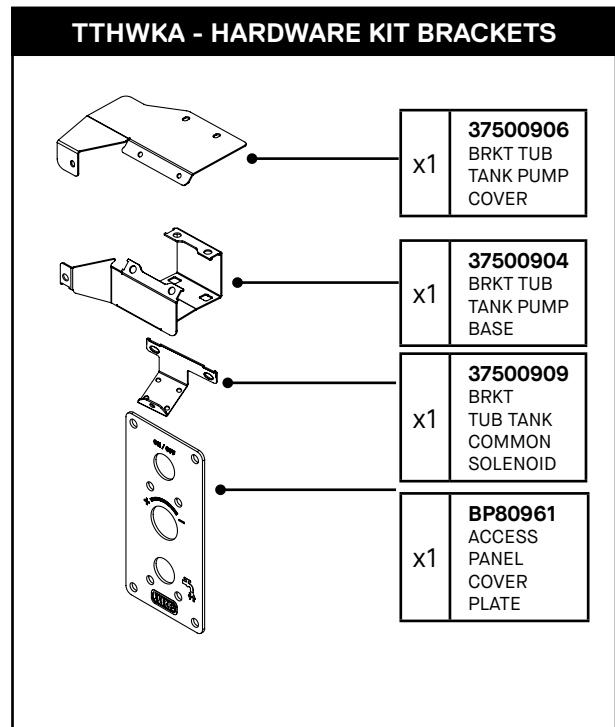
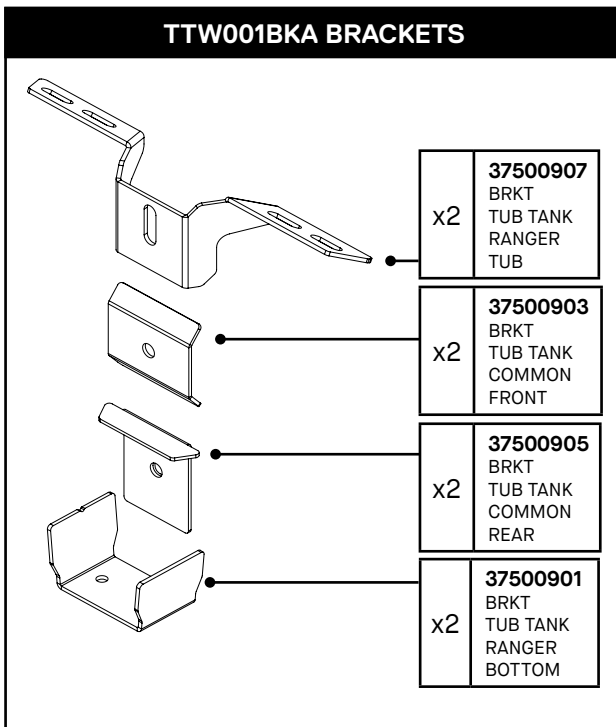

TTHWK HARDWARE BOX 1

Code	Description	Qty	OK
BP80943	JG 12MM TUBE EQUAL TEE	1	
BP80944	JG 12MM TUBE EQUAL ELBOW	6	
BP80945	JG 12MM TUBE to 1/2" BSP F	5	
BP80946	JG 12MM STEM to 1/2" BSP M STRAIGHT	1	
BP80948	JG 1/2" BSP M TO 12mm TUBE SWIVEL ELBOW	1	
BP80949	JG 12mm TUBE STEM ELBOW	3	
BP80950	JG 12mm TUBE EQUAL DIVIDER	1	
BP80992	VENT TO SUIT JG 12MM FITTING	1	
BP80993	FILTER CAGE 15mm STAINLESS STL	1	
BP80953	1/2" ELBOW M TO F	2	
BP80991	PUSH IN FIT RUN TEE 12MM G1/2IN	1	
BP80858	PLUG DIA 25 51753	2	
Packed By		Date	

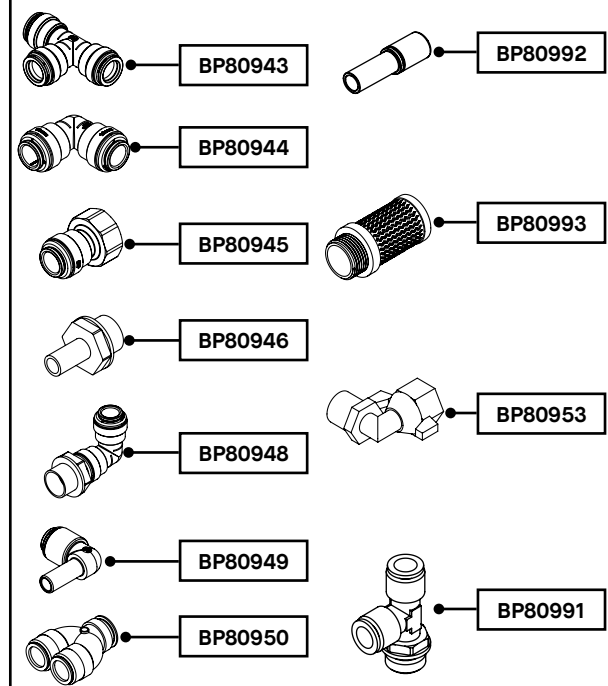
TTHWK HARDWARE BOX 1

TTHWK HARDWARE BOX 2

BP80982	MANIFOLD BLOCK MACHINED	1	
BP80983	BRASS HOSE CONNECTOR	1	
BP80984	HOSE CONNECTOR DUST CAP	1	
BP80985	KNOB ACCESS PANEL TTW	1	
BP80954	1/4 TURN TAP CARTRIDGE	1	
BP80989	SCREW PLUG G1/4 HEX SOCKET	1	
BP80957	12V WATER PUMP	1	
BP80958	12V SOLENOID VALVE	1	
SEPARATE BAG			
BP80987	SCREW M5x20	4	
6151475	NUT U M6x1.0	7	
6151459	SCREW M6x16 BLACK	16	
BP80742	NUT HEX NYLOC M6x1.0 BLACK	4	
BP38781	SCREW STITCH 8GX15MM ECO BLACK	4	
BP80744	M6 FLAT WASHER BLACK	4	
BP80995	27mm TIE BASE ASHESIVE BLACK	5	
BP1191	56404 CABLE TIES(100)	5	
4584347	WASHER FLAT M5	4	
BP80444	CARTON RIM 190x150x105	1	
Packed By		Date	

TTHWK HARDWARE BOX 2
