

FITTING INSTRUCTIONS



DOCUMENT TITLE:

FI-TTW002

TUB TANK: Tub Mounted Water Tank

APPLICATION:

Toyota Hilux 2015+ with ARB drawer systems.

Double- Cabs; GR Sport, Rogue, SR5, Workmate & SR
(Extra-Cab to be confirmed)

NOTE: Does not fit with roller cover or tub liner in place. Remove for fitment.

MODEL NUMBERS:

TTW002FF

FITTING TIME:

Minimum 2.5 Hours

TTWLG - Additional 0.5 Hours

PUBLISHED DATE:

18 November 2025

ADDITIONAL KITS:

TTWLG - Water Level Guage

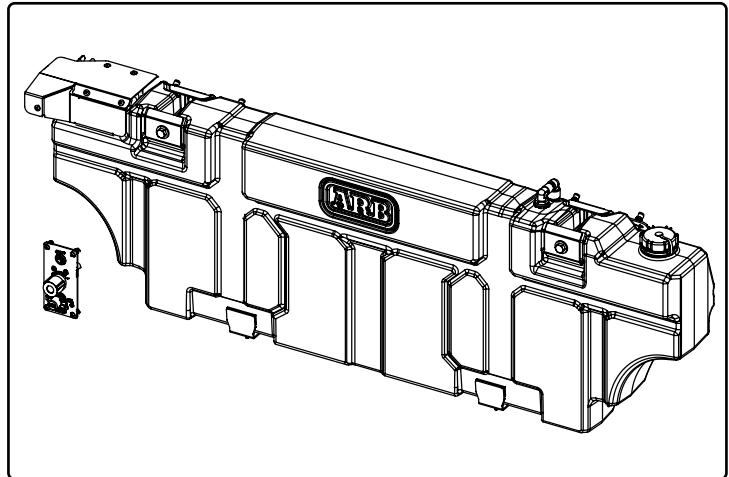

PROUDLY
AUSTRALIAN MADE

Congratulations on your purchase of a ARB Tub Tank.



Anti-seize MUST be used on all threaded fittings into the Tub Tank.

**Follow Torque Specifications detailed in table below and as outlined in instruction steps.
DO NOT OVERTIGHTEN FASTENERS.**

Note:

- REFER TO USER MANUAL PRIOR TO USE
- Do not use this product for any vehicle make or model, other than those specified.
- Do not modify the structure of the Tank in any way, unless otherwise instructed.
- Left and Right hand sides of the vehicle and Tub Tank throughout this instruction are from the view of Looking from the Rear of the vehicle.
- Front of Tub is Toward Front of Vehicle, Rear of Tub is toward Tailgate.
- Please take time to read the instructions before proceeding with fitment of the Tub Tank.
- Ensure all components, as listed in the bill of materials on the back page, are received prior to commencing the fitment. Please retain all hardware until fit-up is complete.
- Ensure these fitting instructions are passed onto the vehicle owner and/or operator.

TOOLS REQUIRED

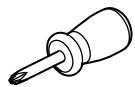

Phillips Head Screw Driver

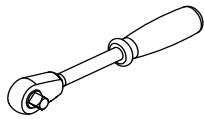

Socket Drive Torque Wrench (5-44Nm)



Allen Key 2, 3, 4, 6 mm

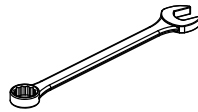

Ring Spanner 10, 13, 14, 16, 17, 22mm



Sockets 10, 13, 14, 16mm



Adjustable Spanner (Set at 28mm)



Tape Measure or Ruler

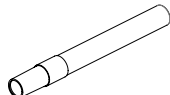

Marker Pen

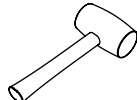

Rubber Mallet

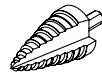

Step Drill Bit 10 - 20mm

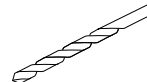

Drill Bit 5, 8, 11mm

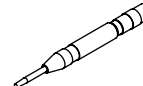

Centre Punch

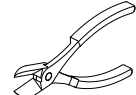

Side Cutters

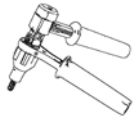

Rivnut / Nutsert Tool (Ratchet Type)



Jigsaw (Sheet metal blade)



Drill



Poly Hose Cutter



Threadlocker (Low/Med Strength)

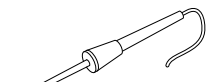

Soldering Iron

WATER TANK & MOUNTING BRACKETS OVERVIEW - TTW002 & TTW002BK

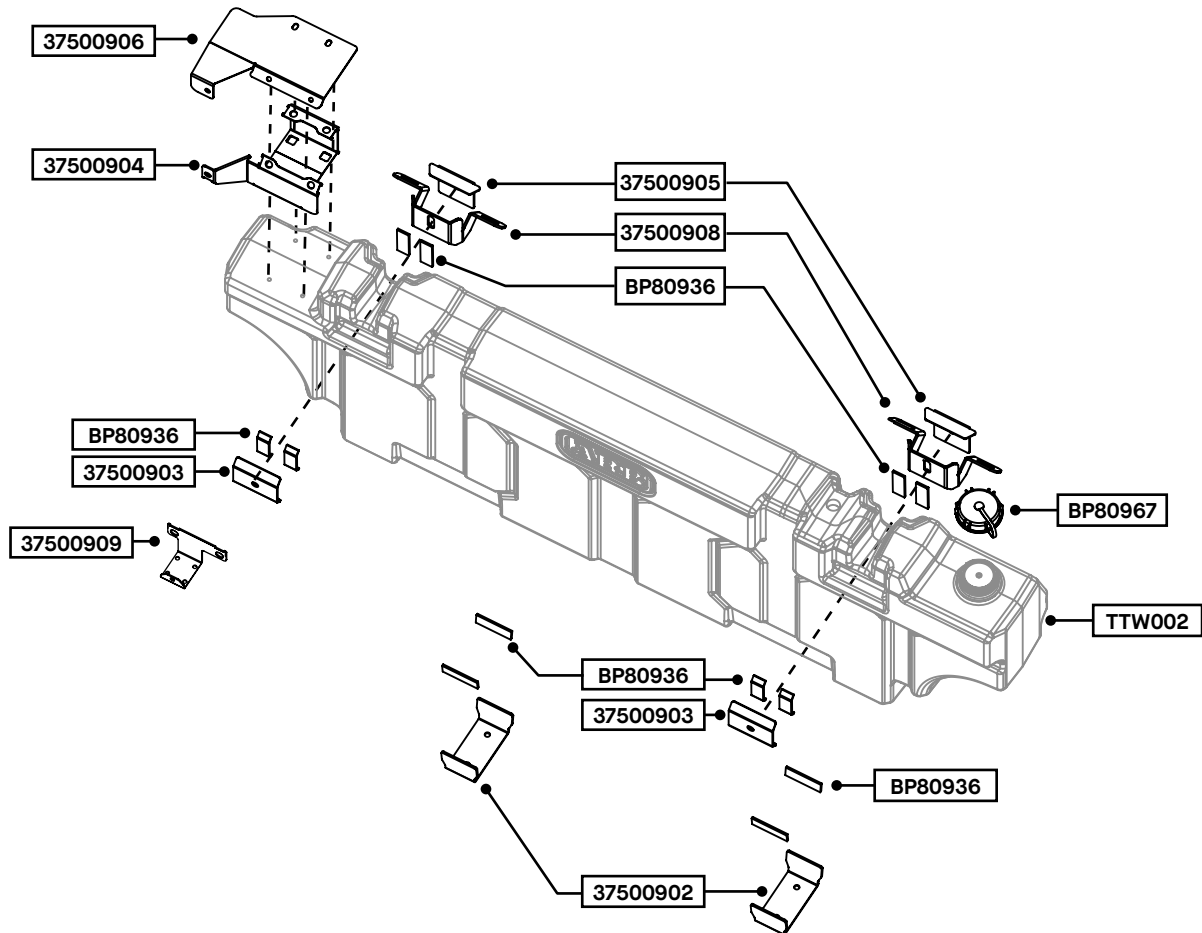

HWK - HARDWARE KIT: ACCESS PANEL

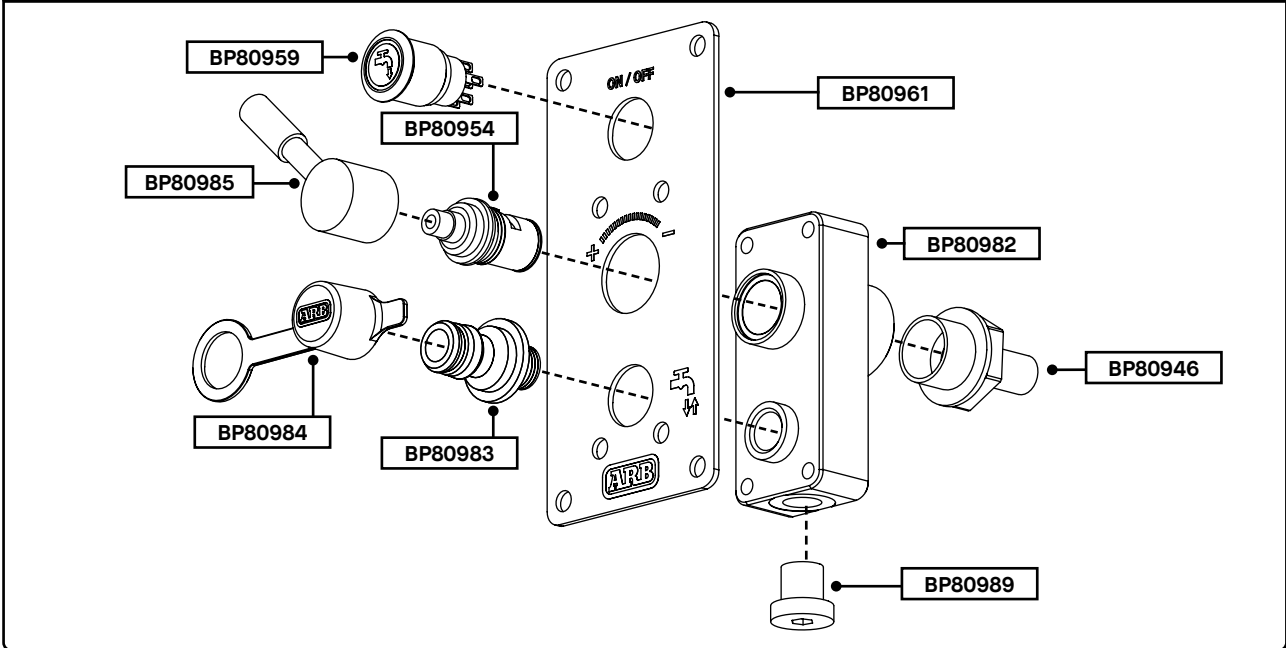

CONTENTS

STEP 1: BRACKET INSTALLATION Pg. 5

STEP 2: TANK ASSEMBLY Pg. 9

STEP 3: ACCESS PANEL ASSEMBLY Pg. 12

STEP 4: HARNESS INSTALLATION Pg. 16

STEP 5: TANK INSTALLATION Pg. 20

PACKING LIST Pg. 28

STEP 1: BRACKET INSTALLATION

1.1

Prepare tub and parts.

Remove tub liner if present.

NOTE: Retain hardware and components until installation complete.

1.2

Install Rubber Pads (BP80936) to brackets as shown.

NOTE: Clean surface of bracket with isopropyl alcohol prior to sticking adhesive pad.

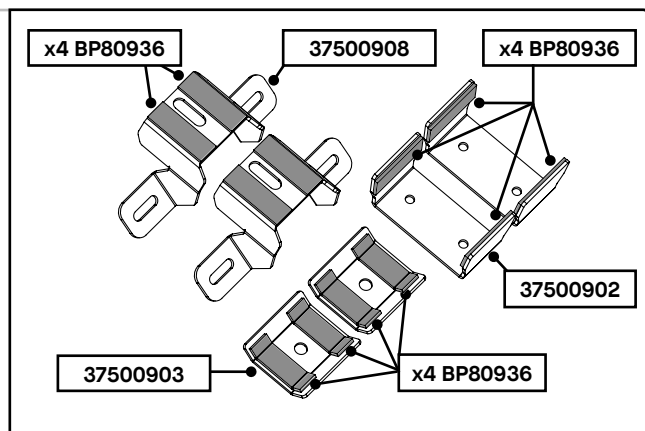

1.3

ARB Drawers Only:

Remove Left and right panels from back of drawers by twisting anti-clockwise.

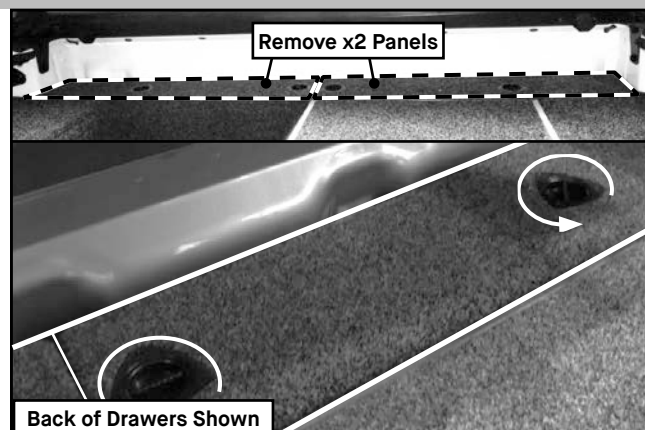

1.4

Remove 4 angled brackets from back of drawers by unscrewing M8 Bolts.

Reinstall M8 bolts to back of drawers once brackets removed.

Tool(s) Required: 13mm Socket, Electric Ratchet

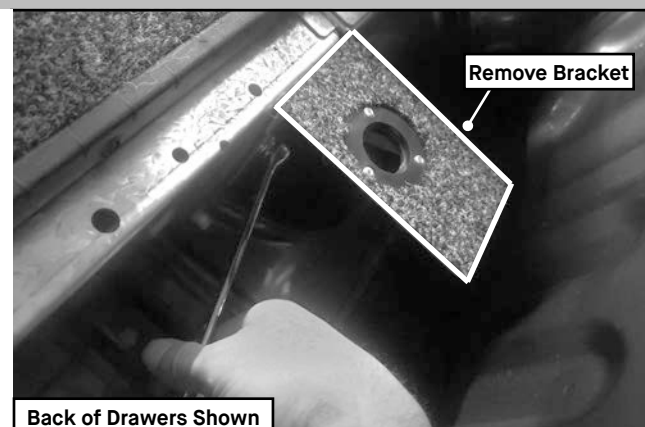

ARB DRAWERS ONLY

1.5

Headboard Brackets Position:

Locate and Mark Centreline of tub with marker

Tool(s) Required: Marker



1.6

Follow instructions on template and position 2 templates on headboard.

Ensure template is properly aligned perpendicular to bottom of tub.

NOTE: Refer to check dimensions on template to ensure template is level.

Tool(s) Required: Tape measure

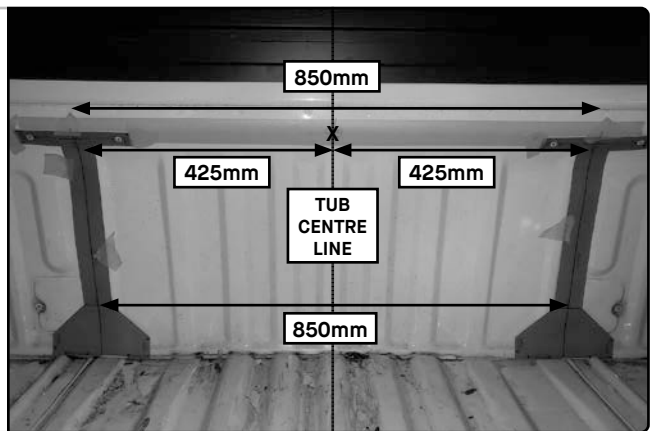

1.7

Centrepunch and drill x4 holes at marked positions to 5mm (pilot hole), then 11mm.

CAUTION: Use drill stop to avoid drilling through to cab.

Apply corrosion protection to exposed metal at edge of holes.

Tool(s) Required: Drill, Centrepunch, 5 & 11mm Drill Bit



1.8

Install x4 M8 nutsert into 11mm holes.

Tool(s) Required: Rivnut tool (Ratchet Type)

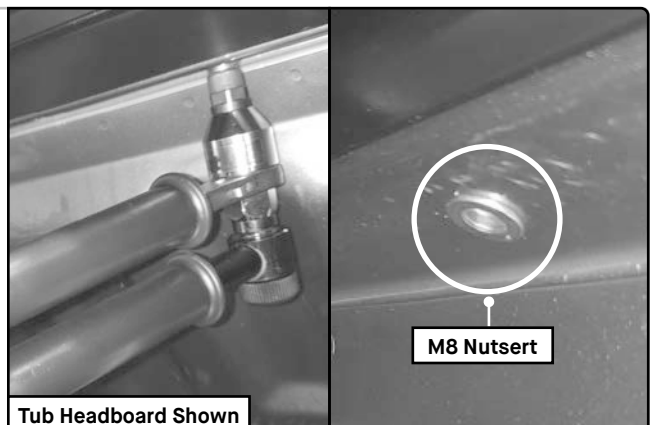

1.9

Install Headboard Bracket (37500908) to nutsert shown using hardware shown.

Repeat other side.

NOTE: Tighten finger tight.

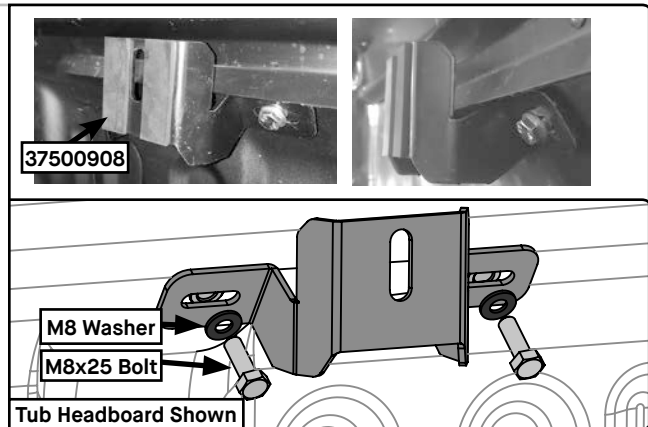

1.10

Bottom Bracket Installation

Mark centreline of tub floor locate centre of rib 265mm either side of the centreline.

Apply x2 templates to floor as per instructions.

Tool(s) Required: Marker, Tape Measure

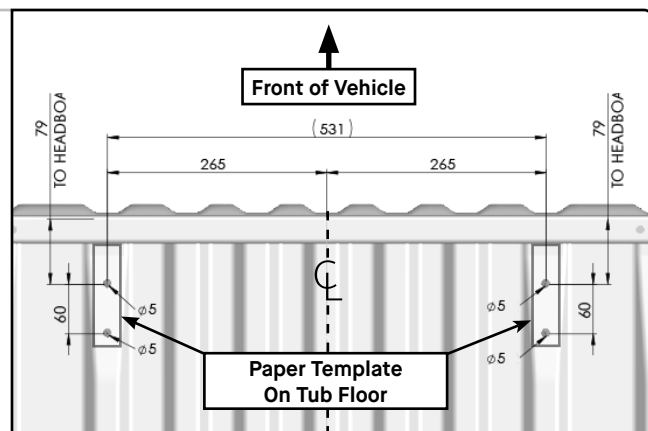

1.11

Refer to template to mark bottom bracket hole positions.

Use centre punch at marked hole locations (as per template) and drill x4, 5mm holes.

Apply corrosion protection to exposed metal at edge of holes.

Tool(s) Required: Tape Measure, Drill, 5mm bit

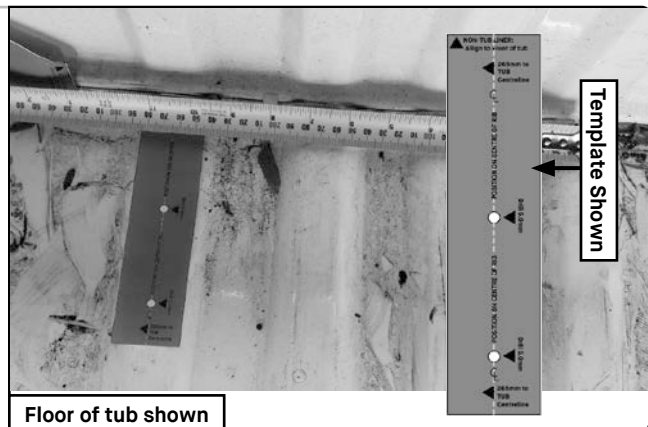

1.12

Install Bottom Brackets

Install Brackets as shown using Rivet (6609087) and M6 Washer.

Repeat other side.

Bottom Brackets Installed.

Tool(s) Required: Rivet Gun

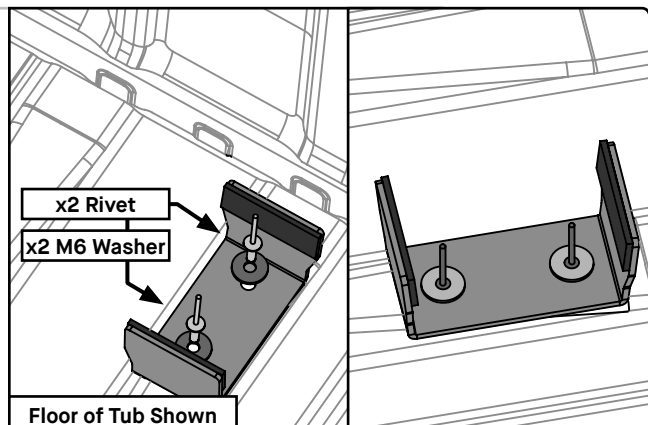

1.13

Measure 40mm from outside corner of tub.

At bottom Right Back corner of tub, centre punch and drill 20mm hole in floor of tub.

Apply corrosion protection paint.

Drill 12mm hole in centre of Grommet (BP80858) and install in tub.

Tool(s) Required: 20mm Step Drill bit, Drill

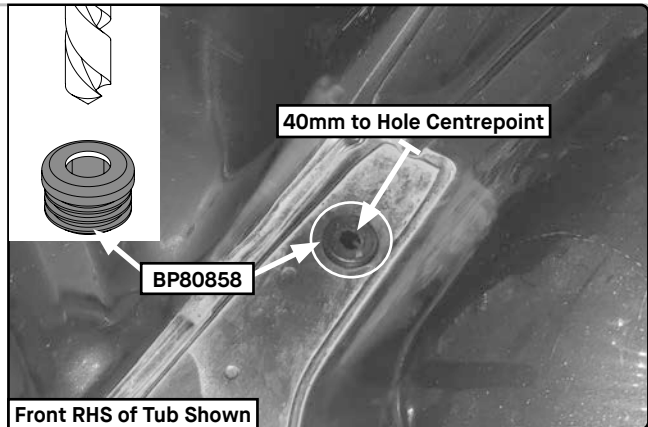
**1.14**

Repeat step 1.13 at Front LHS of tub.

Tool(s) Required: 20mm Step Drill bit, Drill

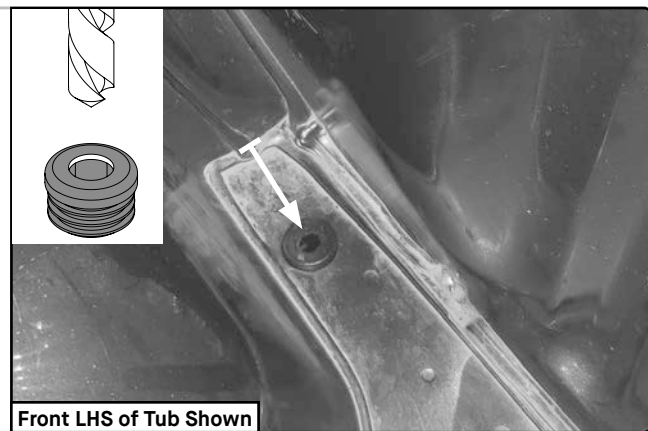
**1.15**

Vacuum bottom of tub thoroughly to clear any swarf from drilling.

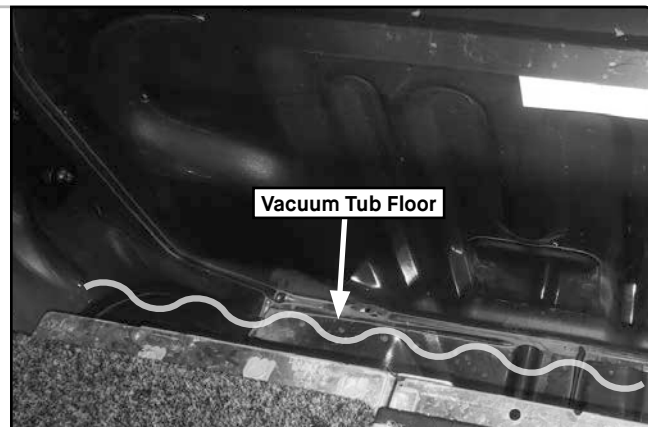

STEP 2: TANK ASSEMBLY
2.1
Prepare Pump

Install fittings as shown.

Press hardware into pump feet as shown.

Tool(s) Required: Adjustable Spanner (1")

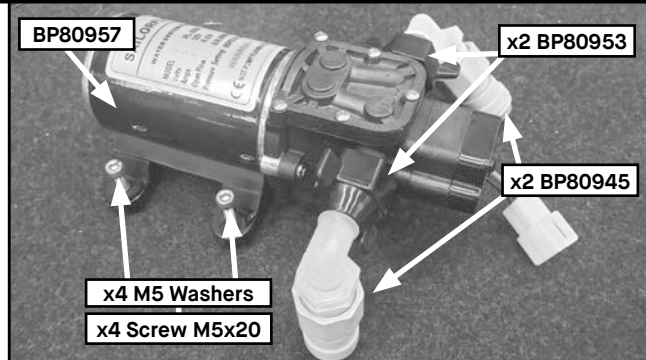
2.2
Prepare Pump Bracket

Press x5, M6 U nuts (6151475) onto Pump Bracket until click is heard.

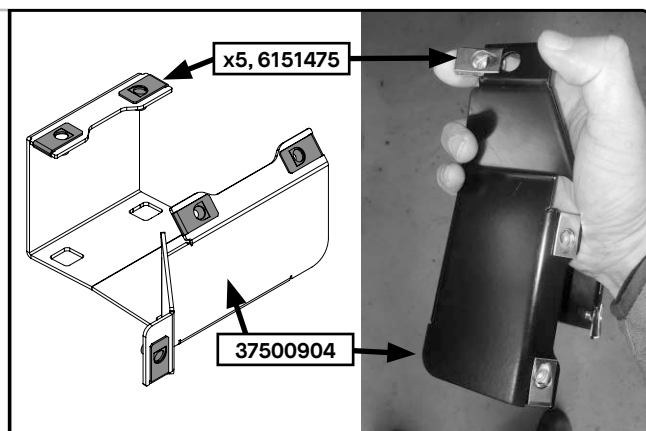

2.3
Install Water Pump (MUST USE ANTISIEZE)

Fasten Water Pump and Water Pump Bracket to M5 inserts in Water Tank.

NOTE: Ensure bracket alignment is straight before tightening fasteners.

M5 Fastener(s): **6Nm**

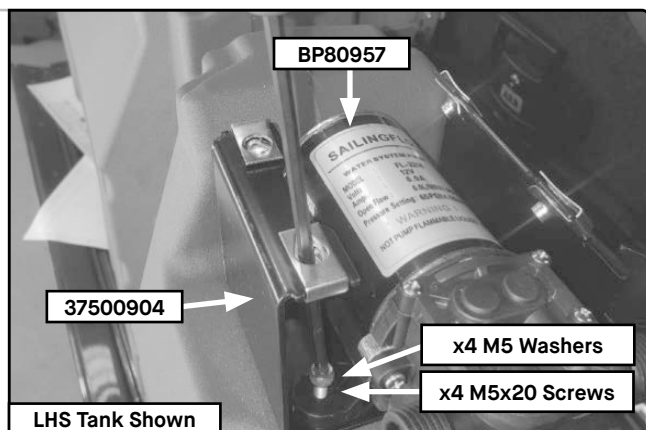
Tool(s) Required: 4mm Allen Key, Torque Wrench, Antisieze

2.4
Install Pump Cover

Fasten Pump Cover to Pump Bracket using hardware shown.

M6 Fastener(s): **9Nm.**

Tool(s) Required: 4mm Allen Key, Torque wrench

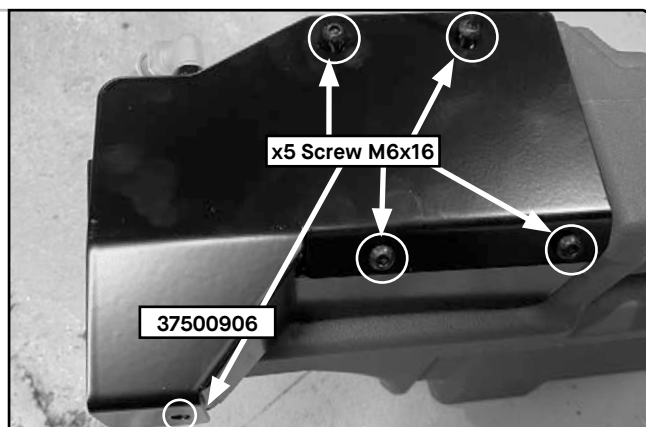

JOHN GUEST INSTALLATION GUIDE

2.5a

Prepare the hose

Ensure the hose is free of score marks.

Cut hose square.

NOTE: Hose Cutters are recommended to achieve a square, clean cut.



2.5b

Push hose up to Hose Stop

Push pipe into fitting, to pipe stop.

⚠ WARNING: If hose is not against stop, it will leak.

Pull To Check Secure

Pull on hose to check it is secure.

Test system before use.

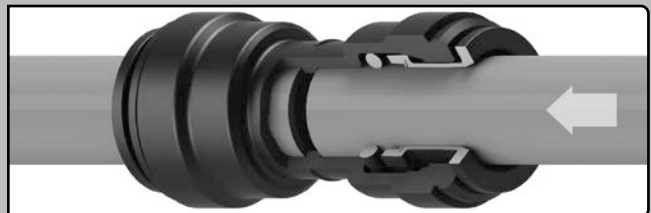

2.5c

⚠ DO NOT:

Do not use damaged or scored hose. Score marks can cause leaks past O-Ring.

⚠ DO NOT:

Do not use hacksaws to cut hose or leave burrs on end of hose.

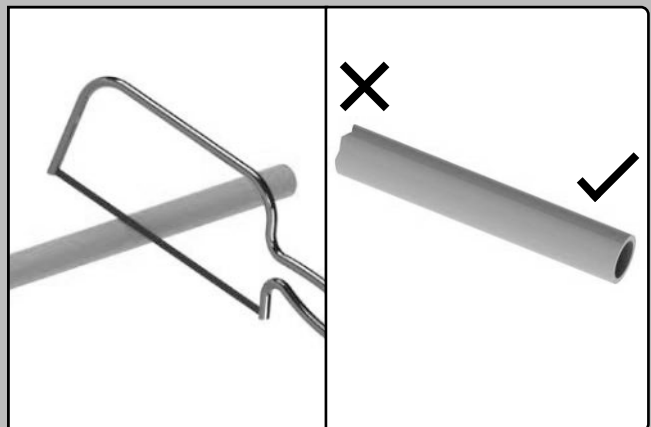

2.5d

How To Disconnect

To disconnect, ensure system is depressurised.

Push collet square against the fitting. With collet held in this position, hose can be removed.



2.6

Cut hose to lengths as shown.

Join Tank outlet/inlet to water pump as shown.

Ensure fittings are tightened and pipe is pushed against stop.

Tool(s) Required: 1" Spanner, Hose Cutter

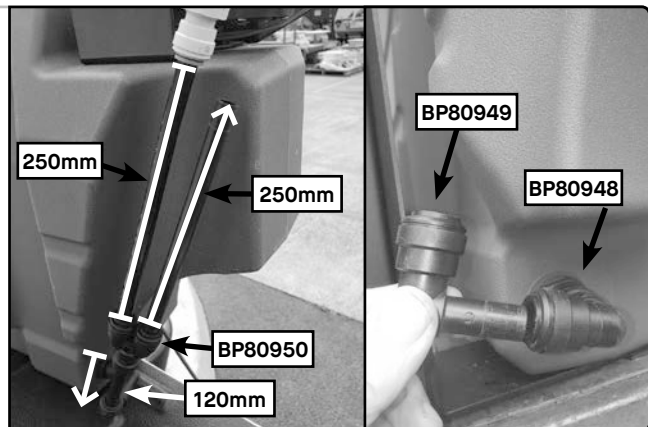
**2.7**

Remove Bung from top of tank.

Install Overflow fitting (BP80991) to 1/2" BSP Threaded insert at top of tank.

 **IMPORTANT: DO NOT OVERTIGHTEN**

Tool(s) Required: 22mm spanner

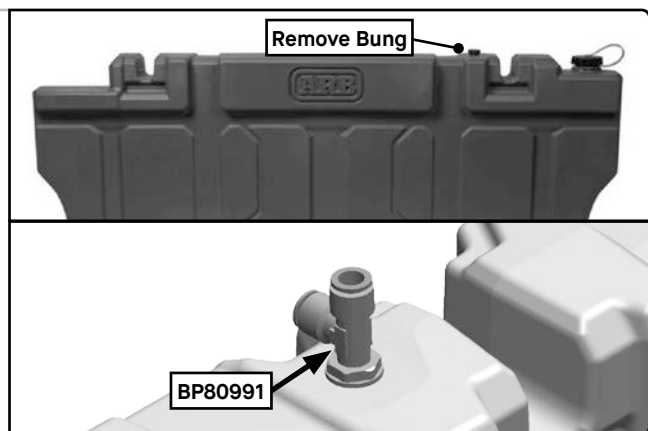
**2.8**

Add 5-10l of water to tank and check for leaks.

Adjust fittings if necessary and drain water.

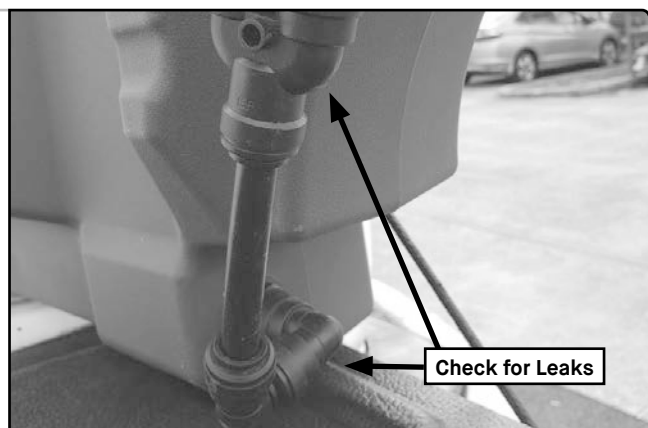

STEP 3: ACCESS PANEL ASSEMBLY & INSTALLATION
3.1

Fasten Panel (BP80961) to Manifold (BP80982) with hardware shown.

M6 Fastener(s): **5Nm.**

IMPORTANT: DO NOT OVERTIGHTEN

Tool(s) Required: 4mm Allen Key, Torque wrench

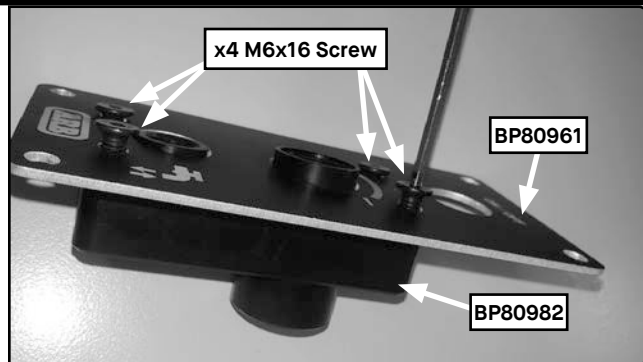
3.2

Install 12V Switch to panel. Align switch as shown and tighten lock nut.

Tool(s) Required: 22mm Spanner

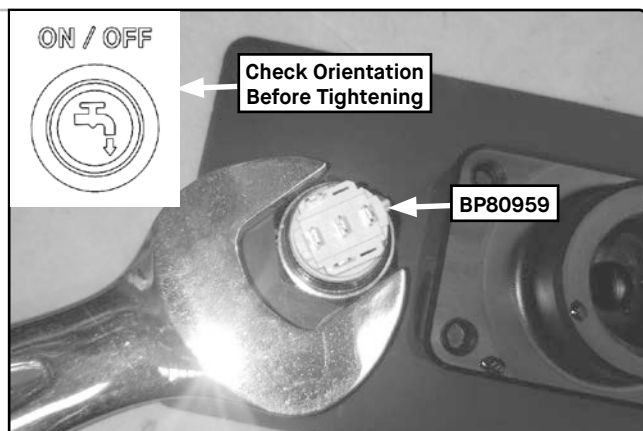
3.3

Install Tap Cartridge (BP80954)

Tap Cartridge(s): **6Nm.**

IMPORTANT: Do not overtighten.

Tool(s) Required: 14mm Socket, Torque Wrench



3.4

Press Dust Cap onto Manifold. Install Hose Connector to Manifold.

Hose Connector: **6Nm.**

IMPORTANT: Do not overtighten.

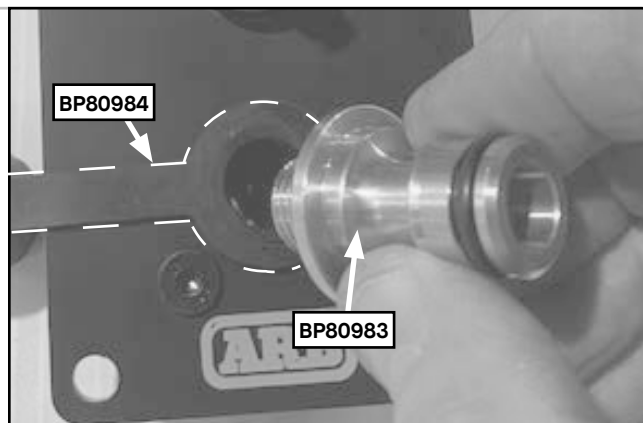
Tool(s) Required: 18mm Spanner



3.5

Confirm tap cartridge spindle is fully open or closed, remove handle from spindle, Loosen grub screw in body, leave in place.

Place Handle onto Cartridge spindle. Confirm grub screw position lines up with '+ -' indicators when tap position 'on/ off'. Press firmly on handle body to engage handle into spline.

Tool(s) Required: Allen Key 2mm

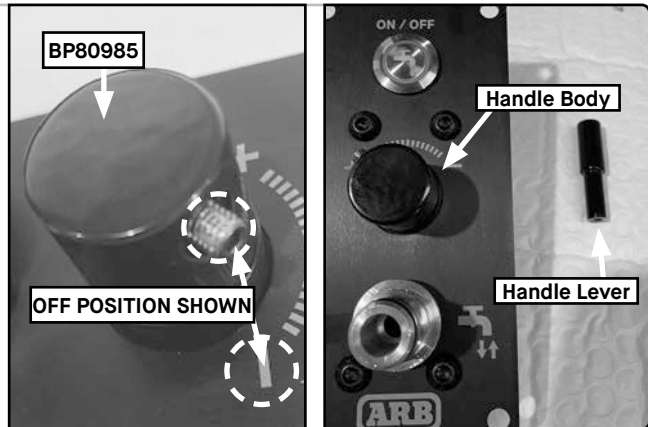

3.6

Remove grub screw, apply threadlocker to grub screw and install into handle.

Tighten grub screw.

Install Handle Lever and tighten.

Tool(s) Required: Allen Key 2mm, Threadlocker (non-permanent)

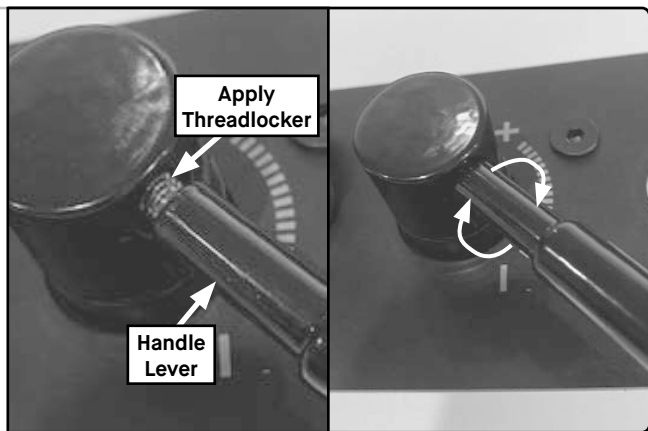

3.7

Install 1/4" BSP Bung into Manifold.

Bung: 6Nm.

IMPORTANT: DO NOT OVERTIGHTEN

Tool(s) Required: 6mm Allen Key, Torque wrench

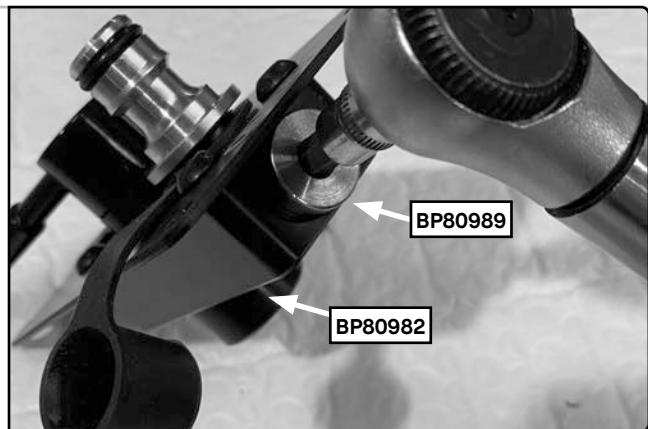

3.8

Install JG 1/2" BSP Stem Fitting to back of access panel as shown.

Access Panel Assembly Complete.

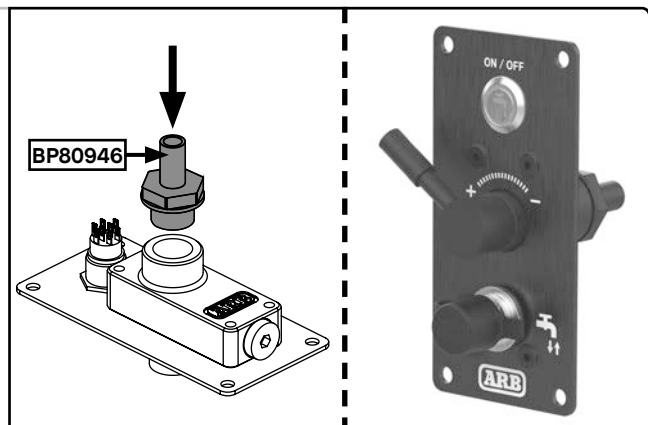

3.9 Access Panel Drawer Wing Fitment:

Remove side cover from drawers to gain access to rear of drawer wing.

NOTE: If accessories are installed in drawer wing area, cover with protective cloth.

NOTE: If fitting drawers at same time as TUB TANK, complete the below steps before installing drawer wings.

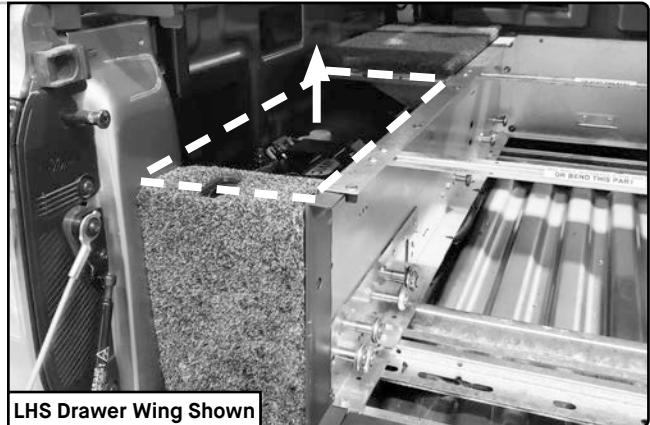

LHS Drawer Wing Shown

3.10 Align Template with LHS panel as per instructions on template. Mark trim lines and hole centres.

NOTE: If installing water level guage, follow instructions as per template.

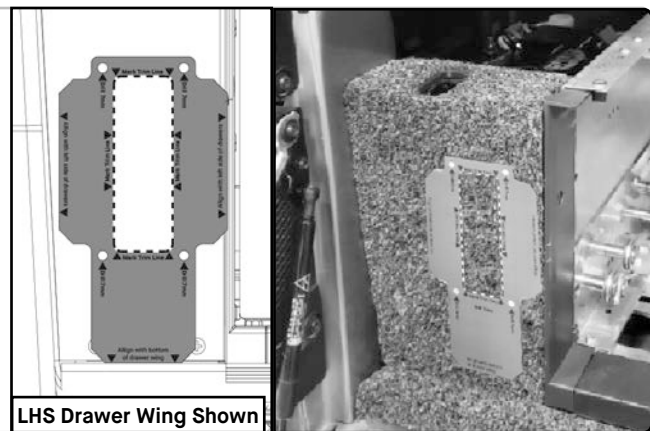

LHS Drawer Wing Shown

3.11 Use paint marker at x8 marked locations as per template.

Tool(s) Required: Paint Marker

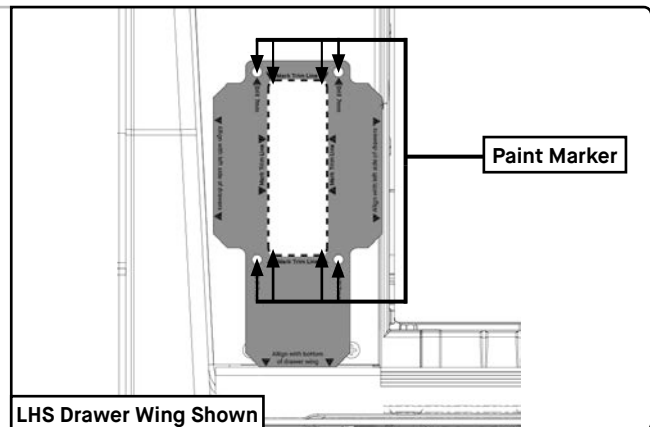

LHS Drawer Wing Shown

3.12 Drill x8 holes to 8mm as per template.

Tool(s) Required: Drill, 8mm Bit (Steel)

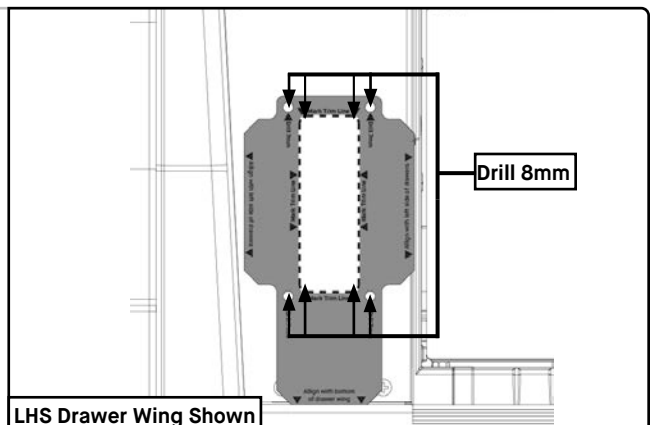

LHS Drawer Wing Shown

3.13

Use Airsaw/ Jigsaw or similar cutting tool to cut out centre as per template.

Apply corrosion protection to edges of sheet-metal after cutting.

If installing water level guage, repeat steps 3.10 to 3.13 as per template.

Tool(s) Required: Airsaw, sheet metal cutting blade

**3.14**

Fit Access Panel to drawer wing as shown using hardware as shown.

NOTE: Water level guage is installed at a later step.

Tool(s) Required: 4mm Allen Key, 10mm Socket

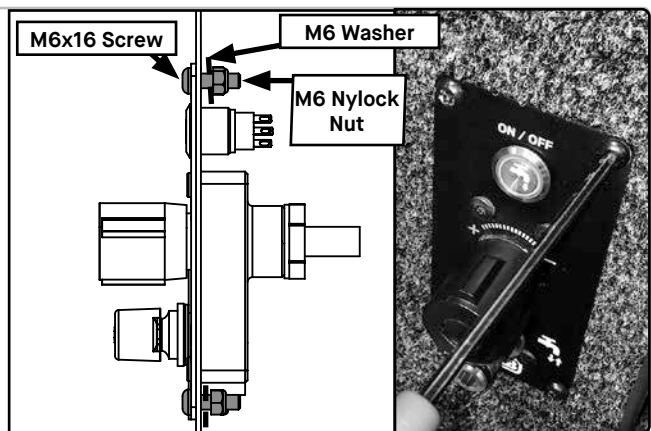
**3.15**

Thoroughly vacuum any swarf.

Access Panel now installed.



STEP 4: Harness Installation

4.1

If not installing water level guage, skip to step 4.9.



4.2

Open TTWLG and assess contents as shown.



TTWLG Kit Shown

4.3

Wiring Installation

Remove tape from yellow switch connector end of harness.

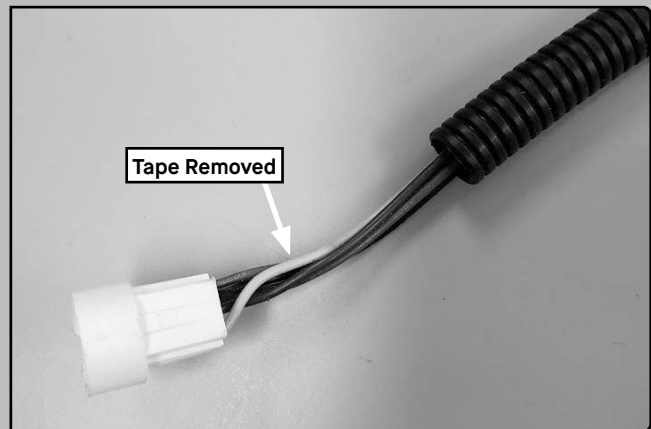

TTWLG ONLY

4.4

Strip back black and red wire, minimum 70mm away from yellow connector, as shown.

USE CAUTION NOT TO SLICE WIRE STRANDS

Tool(s) Required: Cutting Blade

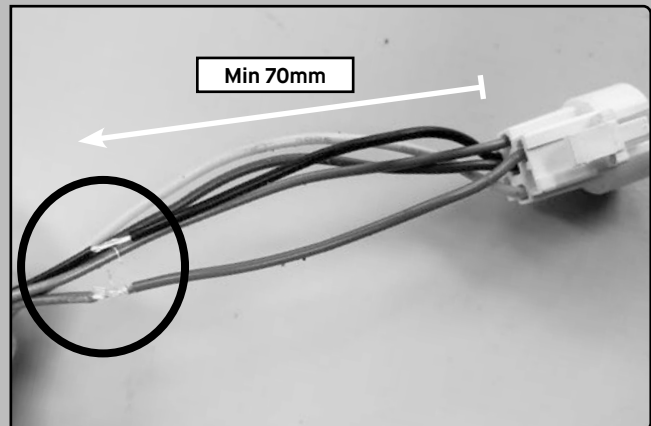

4.5

Cut Topargee Gauge power wire to desired length.

Strip red and black wire to expose approx. 15mm bare wire.

Tool(s) Required: Wire Strippers

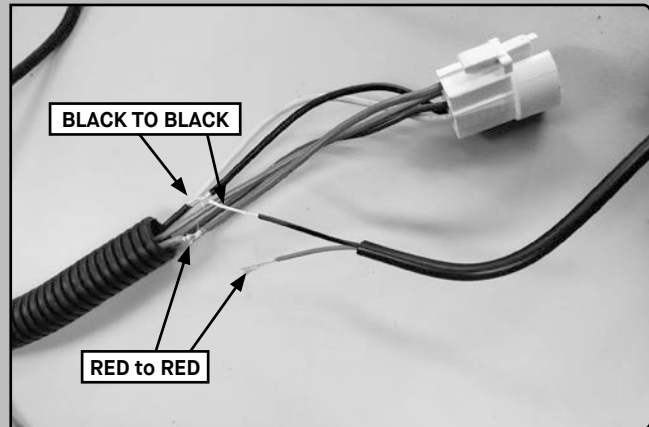
**4.6**

Wrap Topargee red and black wires around stripped back red and black harness wires.

Solder wires and wrap with electrical tape.

Tool(s) Required: Soldering Iron

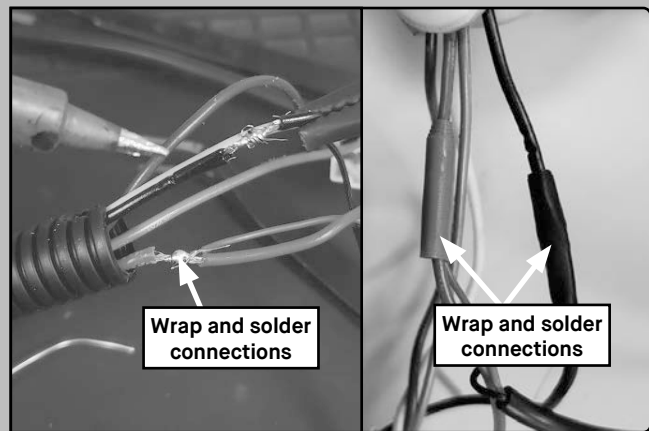
**4.7**

Refit conduit and finish with tape.

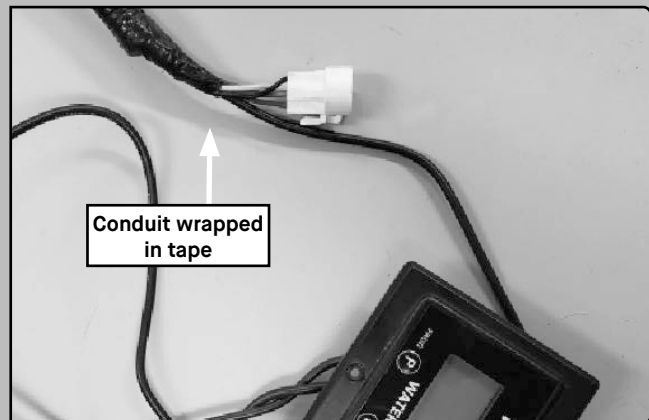
**4.8**

Install LCD Display to drawer wing using instructions supplied with water level gauge.

Complete instructions as normal.



4.9

Disconnect fuse holder and feed wire through grommet in floor of tub at LHS Front.

Push +12V red eyelet and fuse holder through Left grommet in tub, feed down toward left chassis rail (passenger side).

Disconnect fuse holder

Feed this end through Grommet

+12V harness through here

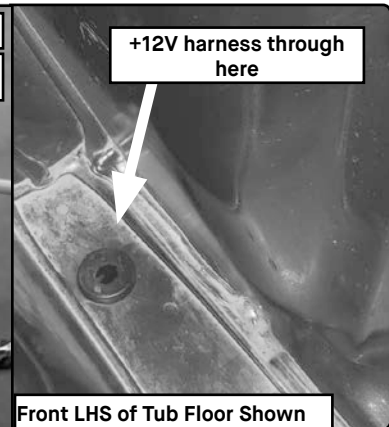
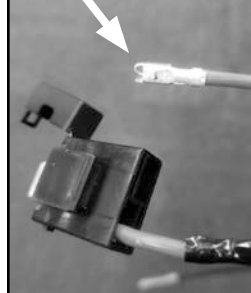

Front LHS of Tub Floor Shown

4.10

Run 12V power lead along chassis toward primary or secondary battery.

Secure wire to chassis rail/ body of vehicle with supplied cable ties.

NOTE: Secondary battery preferred.

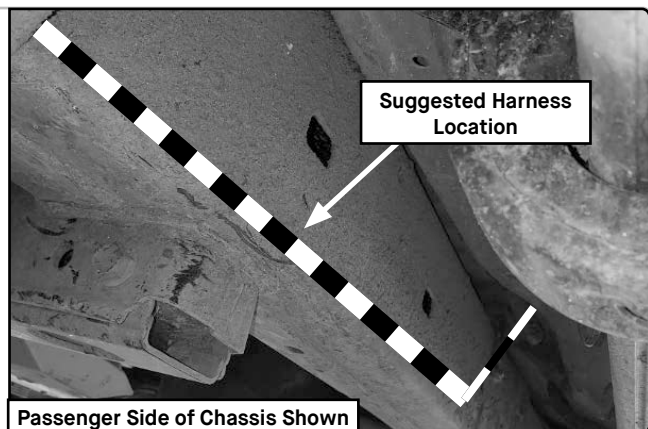

Suggested Harness Location

Passenger Side of Chassis Shown

4.11

Remove 10A fuse from Harness (BP80960) and put aside.

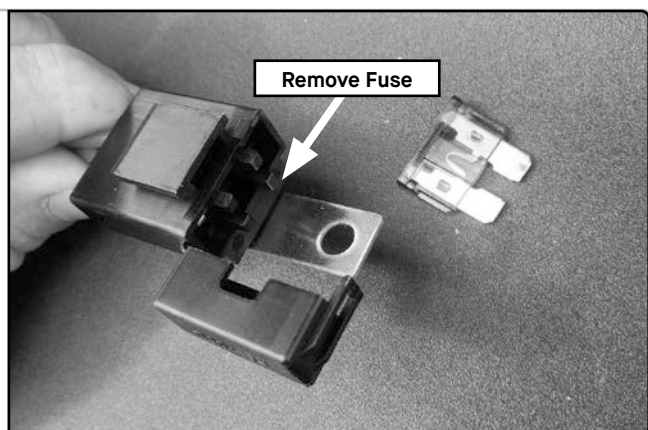

Remove Fuse

4.12

Run wire up firewall towards battery.

Connect red ring terminal to positive battery terminal as shown.

Secure fuse holder to body of vehicle using supplied self tapping screw.

NOTE: Use second battery if present.

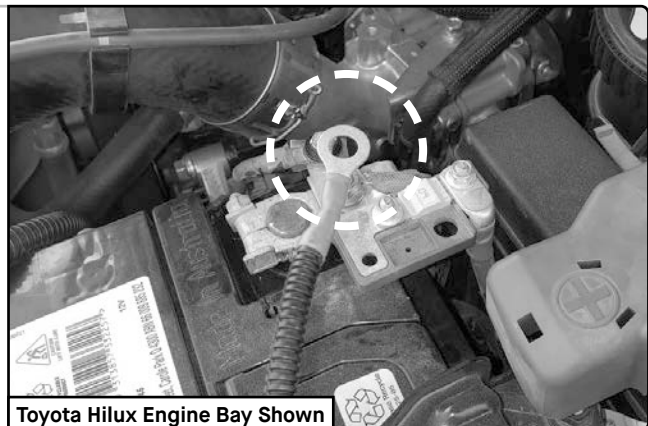

Toyota Hilux Engine Bay Shown

4.13

Attach ground wire of harness to Tub body at tie down point.

NOTE: Use any other ground post if available.

Remaining harness installation to follow after tank installation. Harness to follow path of hose to access panel.

STEP 5: TANK INSTALLATION
5.1

Assemble Overflow fittings as shown.
Cut hose to the following dimensions.

B1 = 380mm
B2 = 350mm
B3 = 250mm

Tool(s) Required: Tube Cutter

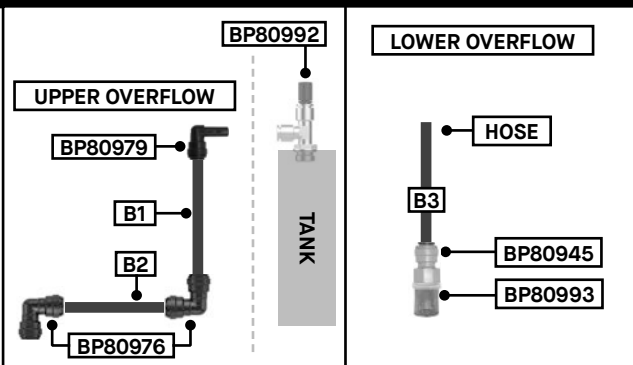
5.2

Place **Upper Overflow** fittings into bottom corner of tub at front of tub.

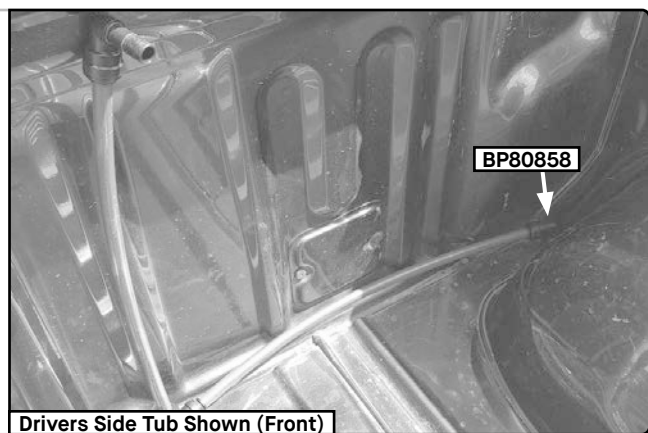

Drivers Side Tub Shown (Front)

5.3

Push **Lower Overflow** through bottom of grommet.

Join Upper Overflow and Bottom Overflow inside tub.

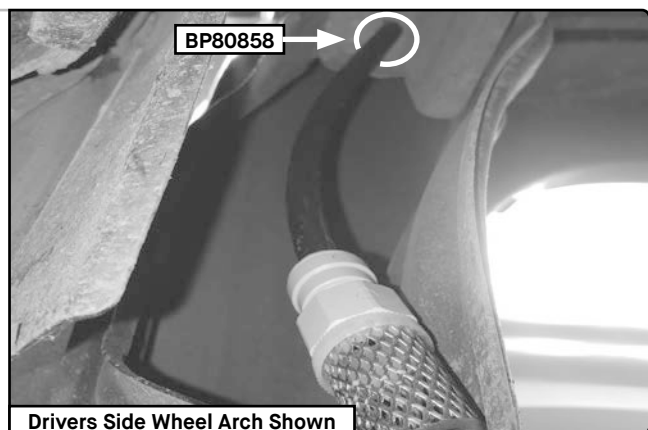

Drivers Side Wheel Arch Shown

5.4

Fit JG Fitting to both ends of Solenoid.

Tighten with spanner.

Tools Required: 1" Spanner

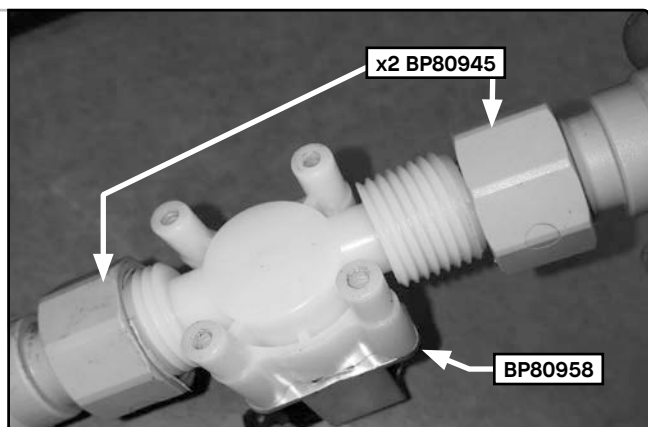

5.5

Fasten Solenoid to Solenoid Bracket using hardware shown.

NOTE: Ensure correct arrow orientation on Solenoid as shown.

Tool(s) Required: Philips Head Screwdriver

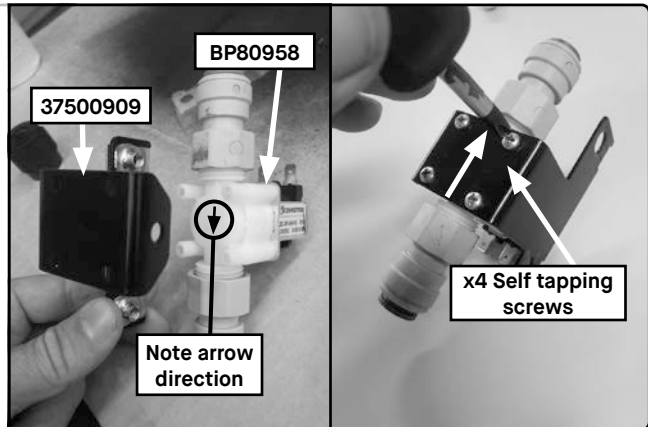

5.6

In front LHS of vehicle tub, connect Harness to Solenoid (BP80958) as shown.

NOTE:

- Solenoid is not polarity sensitive.
- Ensure connectors fully engaged.

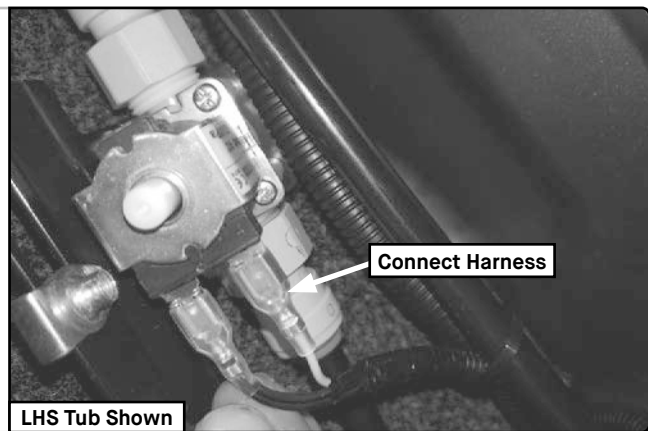

5.7

Connect fittings as shown.

Tool(s) Required: Tube Cutter, 1" Spanner

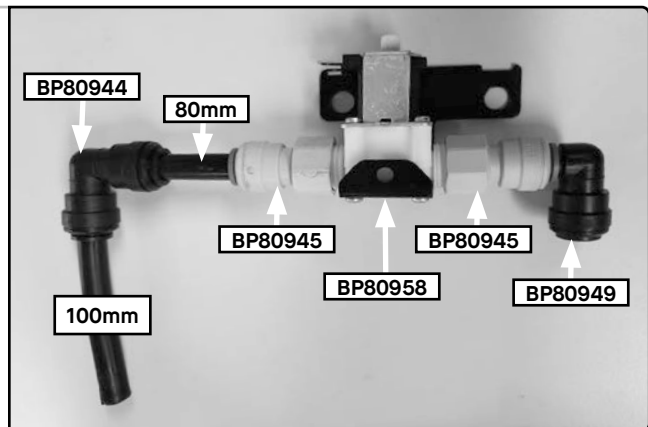

5.8

Install Solenoid to tub using tie down point fasteners at front left of tub.

Follow correct torque specifications.

 Tie Down Points: **22Nm.**

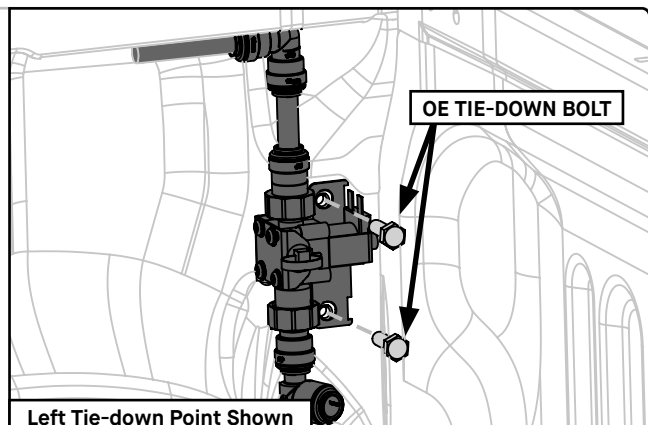

5.9

Place tank in tub of vehicle and connect Harness to Water Pump.

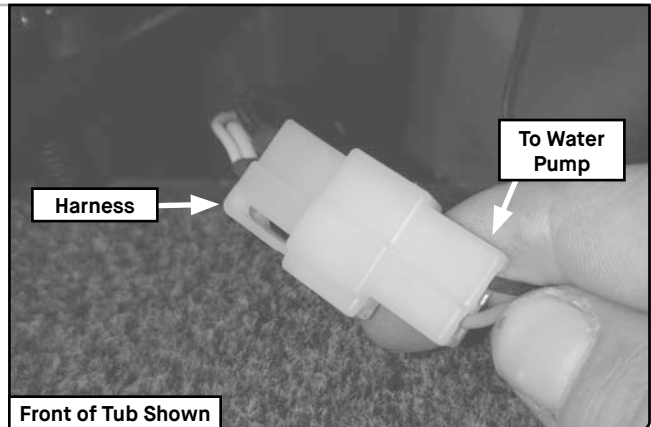

Front of Tub Shown

5.10

Insert tank into cavity until tank is seated on floor of tub.

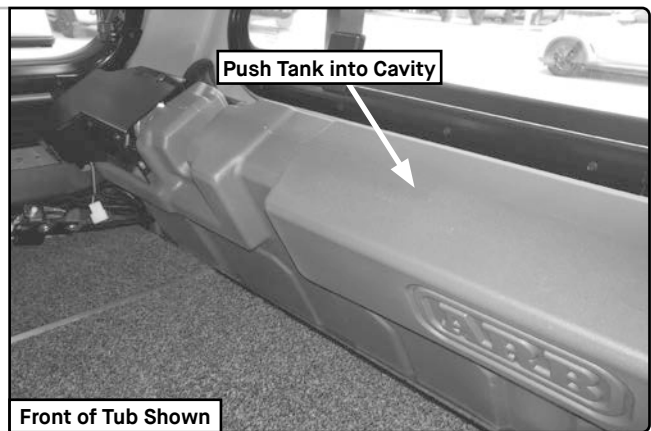

Front of Tub Shown

5.11

Join Hoses and fittings as shown:

Cut JG 12mm Hose to the below lengths.

- H1: 120mm
- H2: 250mm
- H3: 250mm
- H4: 80mm
- H5: 100mm
- H6: 120mm
- H7: 1250mm

Used at a later step:

- H8: 380mm
- H9: 200mm

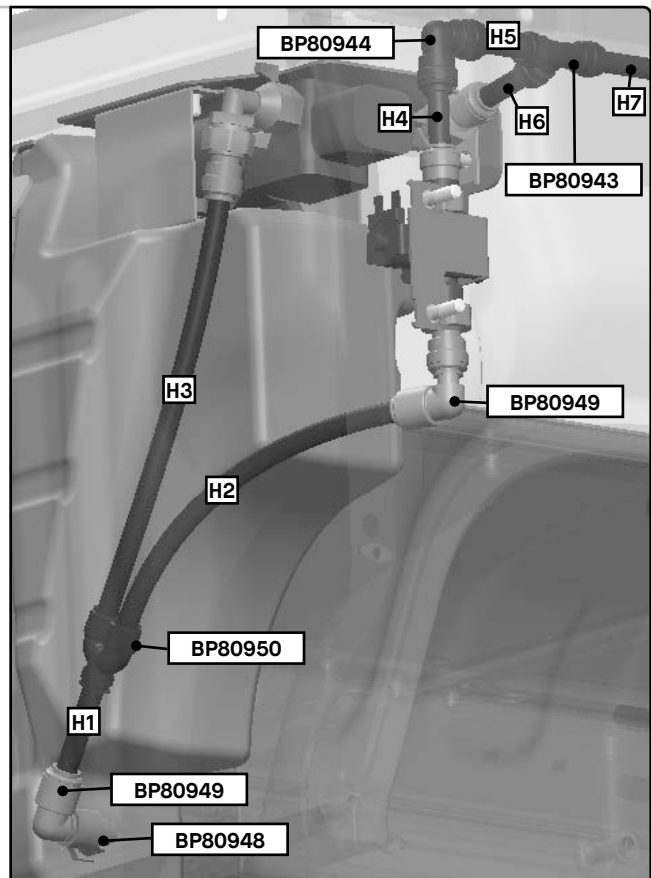

5.12

Connect Upper Overflow Tube to tee fitting (BP80991) in tank.

Press Vent (BP80992) into top of tee.

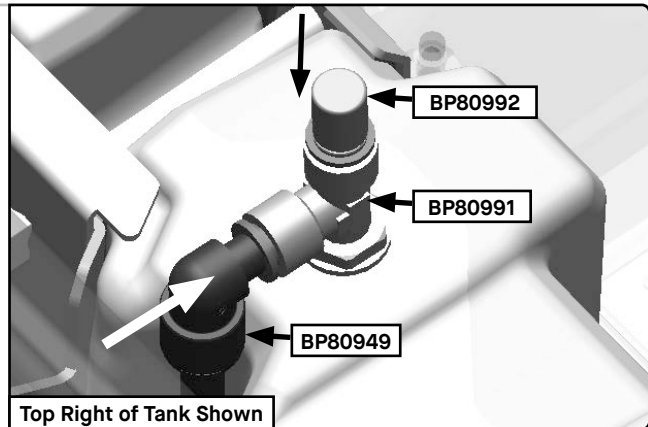

Top Right of Tank Shown

5.13**Install Tank Brackets**

Fit Brackets as shown.

Repeat other side of tank.

NOTE: Use caution not to drop 37500905, TT common rear bracket or tank will need to come out to recover.

Tighten M10 bolts: **8Nm**.

Tool(s) Required: 16mm Socket, Torque Wrench

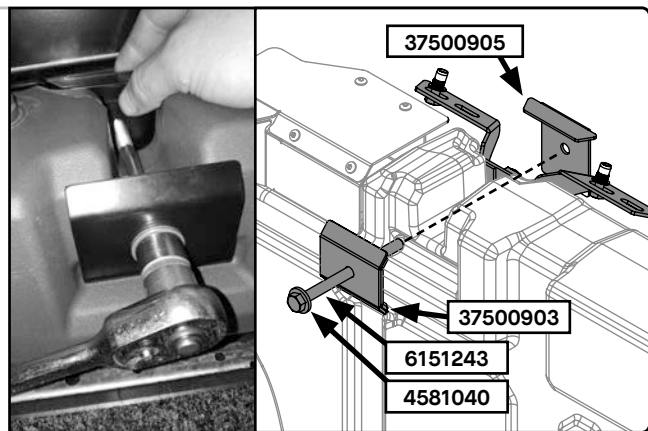
**5.14**

Tighten x2 M8 Fasteners as shown.

Repeat other side of tank.

Tool(s) Required: 13mm Spanner

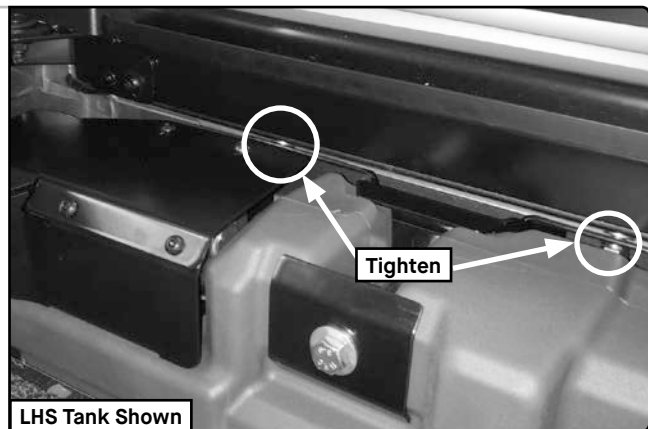

LHS Tank Shown

5.15

Connect remaining hoses and fittings as shown.

Refer to step 5.11 for hose lengths.

H8: 380mm

H9: 200mm

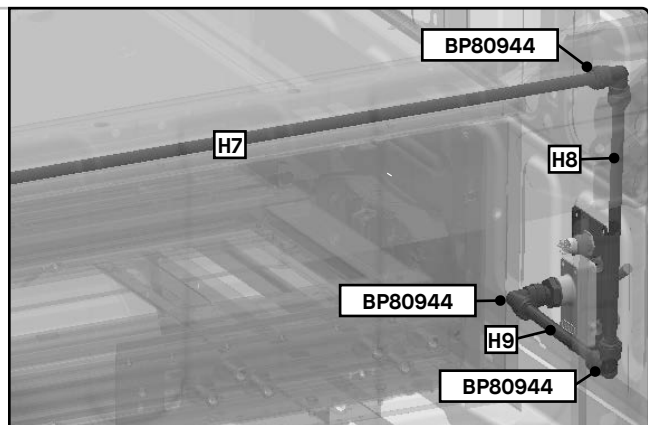

5.16

If **not** installing Topargee water level guage, skip to step 5.18.

Install x2 BP80945 fittings to 12V sender and tighten.

Tool(s) Required: 1" Spanner

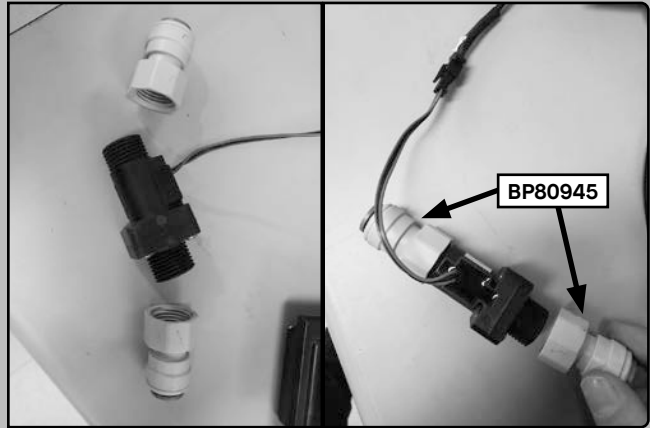

5.17

Cut 80mm from centre of **H7**.

Connect sender inline with **H7**.

Connect +12V plug to sensor.

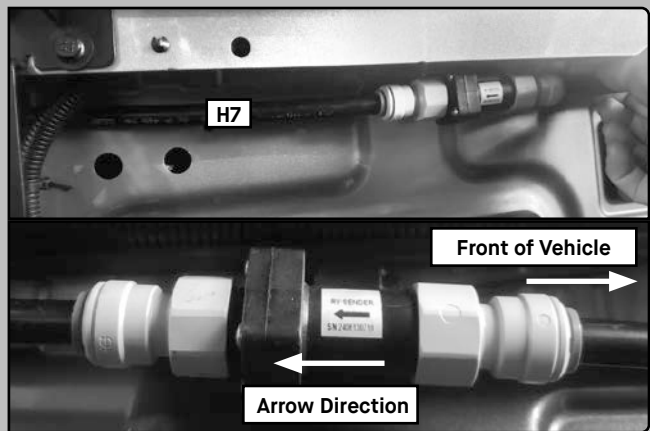

5.18

Bundle Hose and Harness.

Use cable ties to bundle hose and harness under tub rail.

Use Adhesive Cable ties (BP80995) ties to fasten harness and hose under tub rail.

NOTE: Clean surface with isopropyl alcohol before sticking to tub.

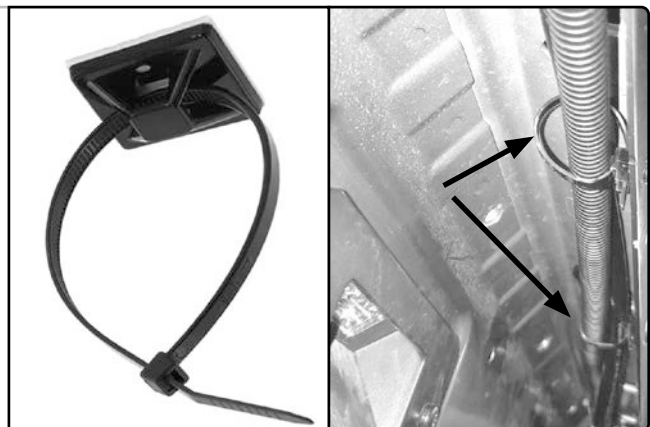

5.19

Check hoses are connected as shown.

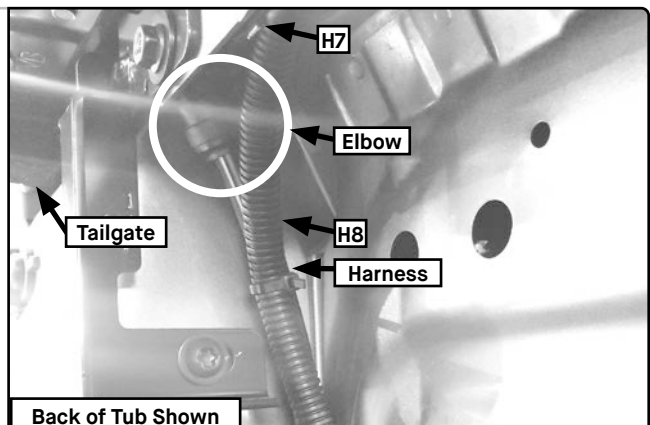

5.20

Connect to Access Panel

Connect Harness to rear of switch on access panel.

Connect fitting and hose to Access Panel as shown.

Hoses and harness are now connected.

Re-Install side cover to drawer wings.

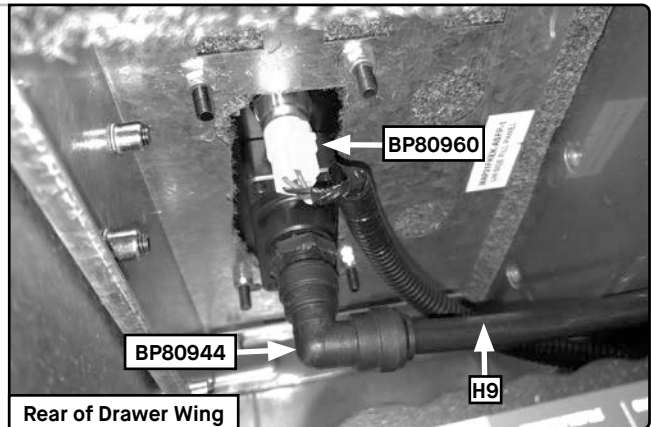

5.21

Reinsert 10A fuse.

Place OWNERS MANUAL in glove box of vehicle.

INSTALLATION COMPLETE.

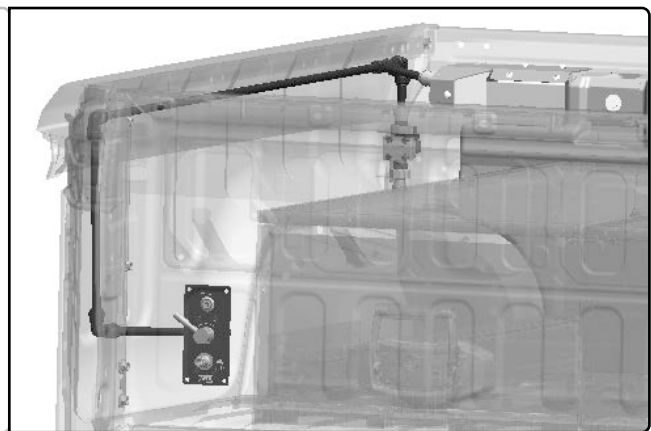

INSTALL COMPLETE

 Important checks once the Water Tank is fitted.

- Ensure all bolts are tensioned correctly.
- Ensure all fittings are correctly tightened, are leak free, pushfit fittings installed correctly.
- All wiring is clear of sharp edges, hot surfaces, and moving surfaces and correctly secured.

Tub Tank Operation Testing Procedure:

- 1.1 Check Pump powers on and switch illuminates.
- 1.2 Fill Tank with clean drinking water. Check top hose connections.
- 1.3 Power on pump and check flow of water.
- 1.4 Check for any leaks and adjust fittings as required.
- 1.5 If flow is poor or unstable, or pump fails to prime - Refer to OWNERS MANUAL for troubleshooting procedure.



TTW002FF			
Code	Description	Qty	OK
TTW002ASSY	TTW002 HILUX ASSY	1	
TTW002BK	TTW002 BRACKET KIT	1	
TTHWKA	TTWKA HARDWARE KIT	1	
TTHWKBOX1	TTWK BOX 1	1	
TTHWKBOX2	TTWK BOX 2	1	
BP80942	JG 12MM TUBE BLACK	4m	
BP1191	56404 CABLE TIES (100)	1	
BP80960	WIRING LOOM	1	
FI-TTW002-A	HILUX FITTING INSTRUCTIONS	1	
TT-TTW002-A3-A	HILUX TRIM TEMPLATE	1	
OM-TTW-A5-A	TUB TANK OWNERS MANUAL	1	
Packed By		Date	

TTW002BK - TTW001 BRACKET KIT			
Code	Description	Qty	OK
TTW002BKA	TTW002 BRACKET KIT BOXED	1	
SEPARATE BAG			
BP80936	ADHESIVE RUBBER PAD	12	
6151243	BOLT M10x1.5x130	2	
4581040	WASHER FLAT M10x25x3	2	
6151022	BOLT M8x1.25x25	4	
4581044	WASHER FLAT M8x17x1.6	4	
6152273	NUTSERT M8x1.25	4	
6609087	RIVET 3/16 DIA 4.8-11.1	4	
BP80607	PLASTIC BAG 400X300X100	1	
Packed By		Date	

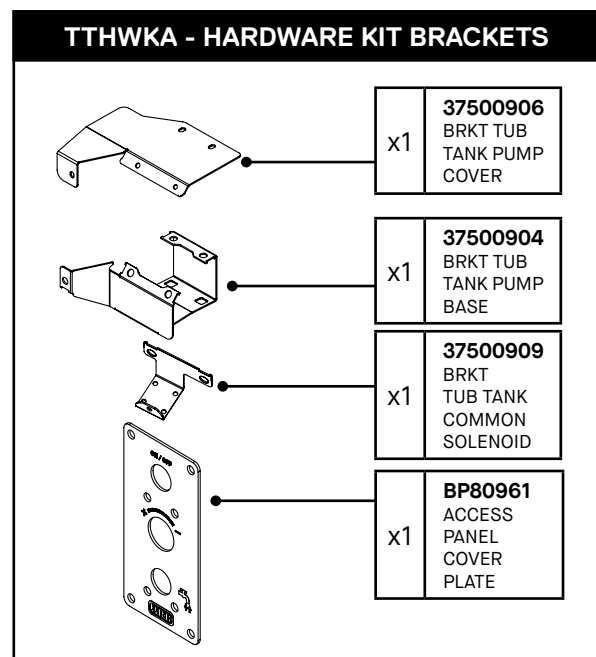
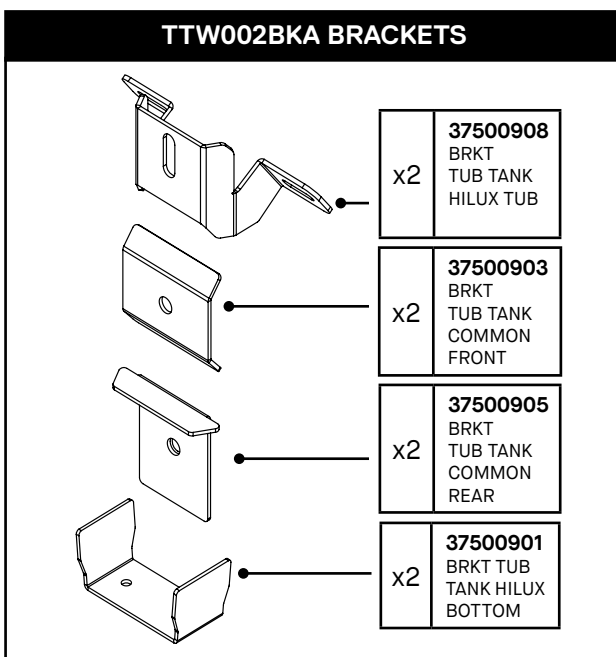

TTHWK HARDWARE BOX 1

Code	Description	Qty	OK
BP80943	JG 12MM TUBE EQUAL TEE	1	
BP80944	JG 12MM TUBE EQUAL ELBOW	6	
BP80945	JG 12MM TUBE to 1/2" BSP F	5	
BP80946	JG 12MM STEM to 1/2" BSP M STRAIGHT	1	
BP80948	JG 1/2" BSP M TO 12mm TUBE SWIVEL ELBOW	1	
BP80949	JG 12mm TUBE STEM ELBOW	3	
BP80950	JG 12mm TUBE EQUAL DIVIDER	1	
BP80992	VENT TO SUIT JG 12MM FITTING	1	
BP80993	FILTER CAGE 15mm STAINLESS STL	1	
BP80953	1/2" ELBOW M TO F	2	
BP80991	PUSH IN FIT RUN TEE 12MM G1/2IN	1	
BP80858	PLUG DIA 25 51753	2	
Packed By		Date	

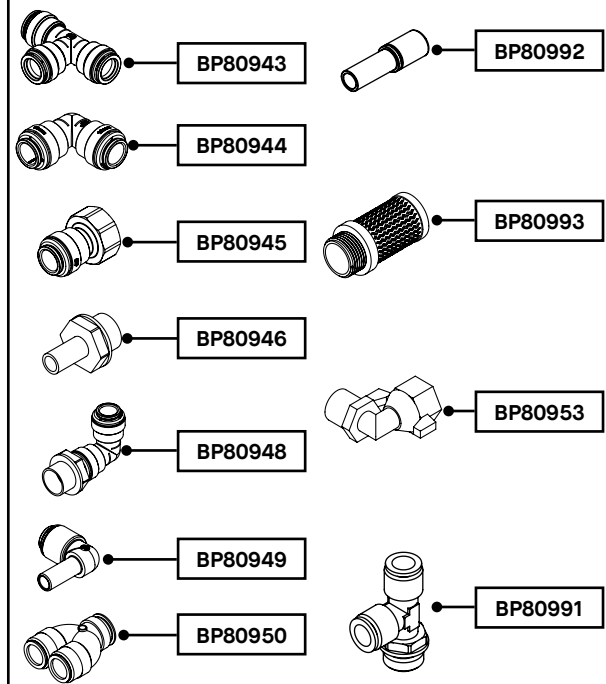
TTHWK HARDWARE BOX 1

TTHWK HARDWARE BOX 2

BP80982	MANIFOLD BLOCK MACHINED	1	
BP80983	BRASS HOSE CONNECTOR	1	
BP80984	HOSE CONNECTOR DUST CAP	1	
BP80985	KNOB ACCESS PANEL TTW	1	
BP80954	1/4 TURN TAP CARTRIDGE	1	
BP80989	SCREW PLUG G1/4 HEX SOCKET	1	
BP80957	12V WATER PUMP	1	
BP80958	12V SOLENOID VALVE	1	
SEPARATE BAG			
BP80987	SCREW M5x20	4	
6151475	NUT U M6x1.0	7	
6151459	SCREW M6x16 BLACK	16	
BP80742	NUT HEX NYLOC M6x1.0 BLACK	4	
BP38781	SCREW STITCH 8GX15MM ECO BLACK	4	
BP80744	M6 FLAT WASHER BLACK	4	
BP80995	27mm TIE BASE ASHESIVE BLACK	5	
BP1191	56404 CABLE TIES(100)	5	
4584347	WASHER FLAT M5 BLACK	4	
BP80444	CARTON RIM 190x150x105	1	
Packed By		Date	

TTHWK HARDWARE BOX 2
